



HERITAGE

- REDROW -

THE BELVOIR

ONE BEDROOM HOME



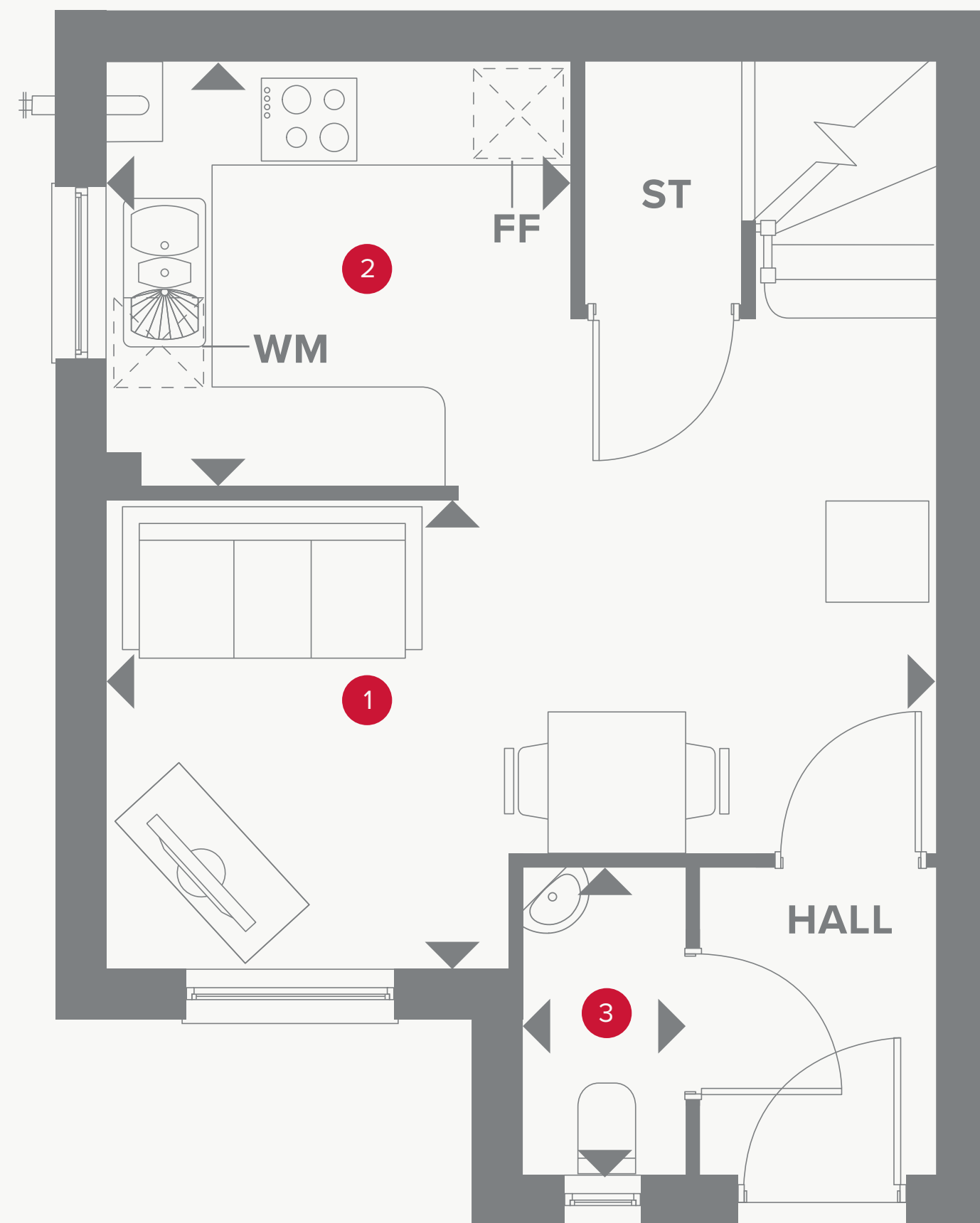

THE BELVOIR GROUND FLOOR

1	Lounge/Dining	16'1" x 10'0"	4.90 x 3.06 m
2	Kitchen	8'9" x 8'4"	2.71 x 2.57 m
3	Cloaks	5'11" x 3'1"	1.81 x 0.95 m



KEY

- Hob
- FF** Fridge/freezer
- WM** Washing machine space

- Dimensions start
- ST** Storage cupboard

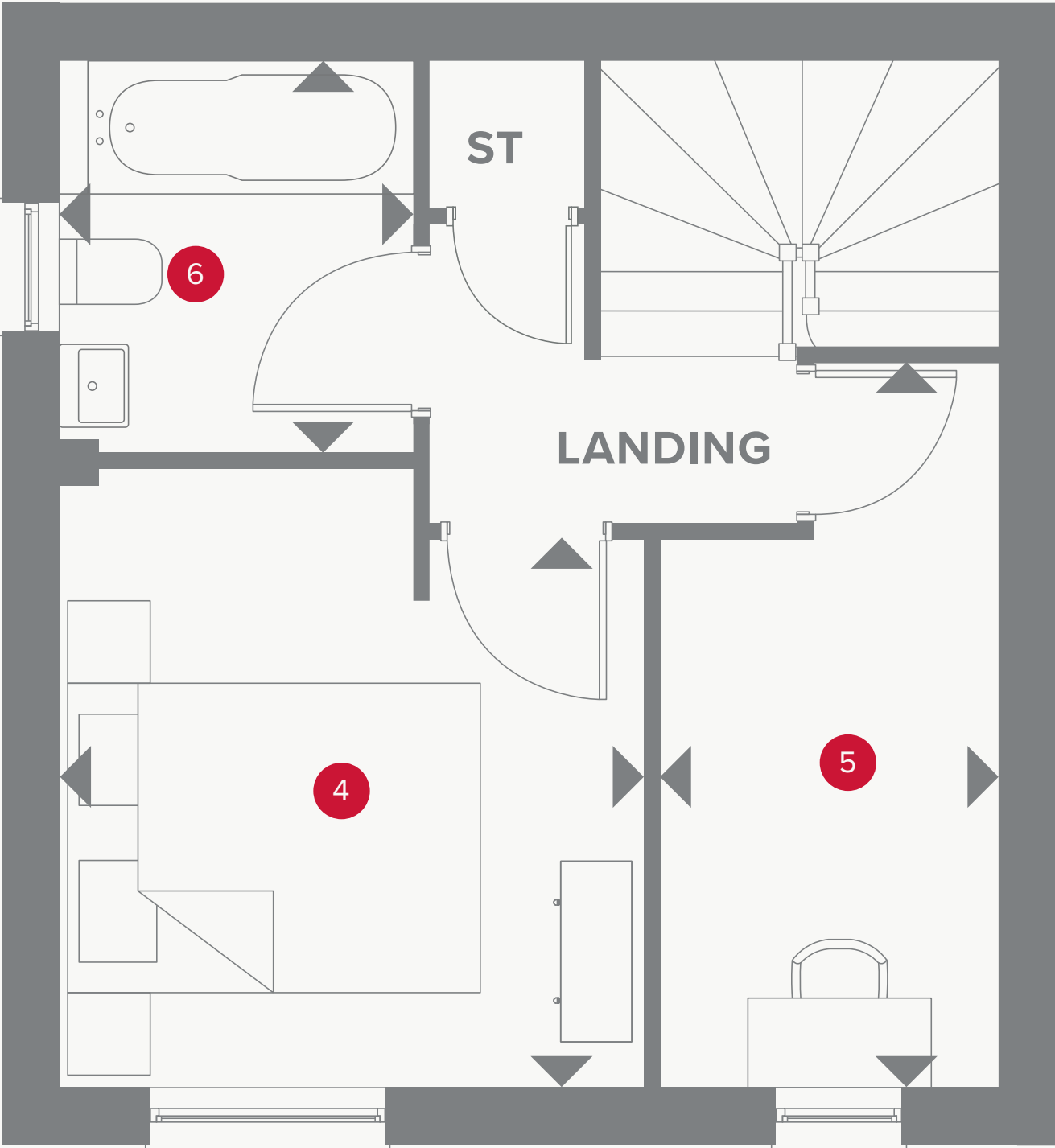

THE BELVOIR FIRST FLOOR

4	Bedroom 1	10'10" x 10'6"	3.31 x 3.21 m
5	Study	12'2" x 5'6"	3.74 x 1.73 m
6	Bathroom	6'9" x 5'7"	2.05 x 1.70 m



KEY

- ◀ Dimensions start
- ST Storage cupboard

CONSUMER
CODE FOR
HOME BUILDERS

www.consumercode.co.uk

Customers should note this illustration is an example of the Belvoir house type. All dimensions indicated are approximate and the furniture layout is for illustrative purposes only. Homes may be 'handed' (mirror image) versions of the illustrations, and may be detached, semi-detached or terraced. Materials used may differ from plot to plot including render and roof tile colours. Detailed plans and specifications are available for inspection for each plot at our Sales Centre during working hours and customers must check their individual specifications prior to making a reservation.