



**HERITAGE**

- REDROW -

# THE BRADGATE

TWO BEDROOM HOME

 **REDROW**

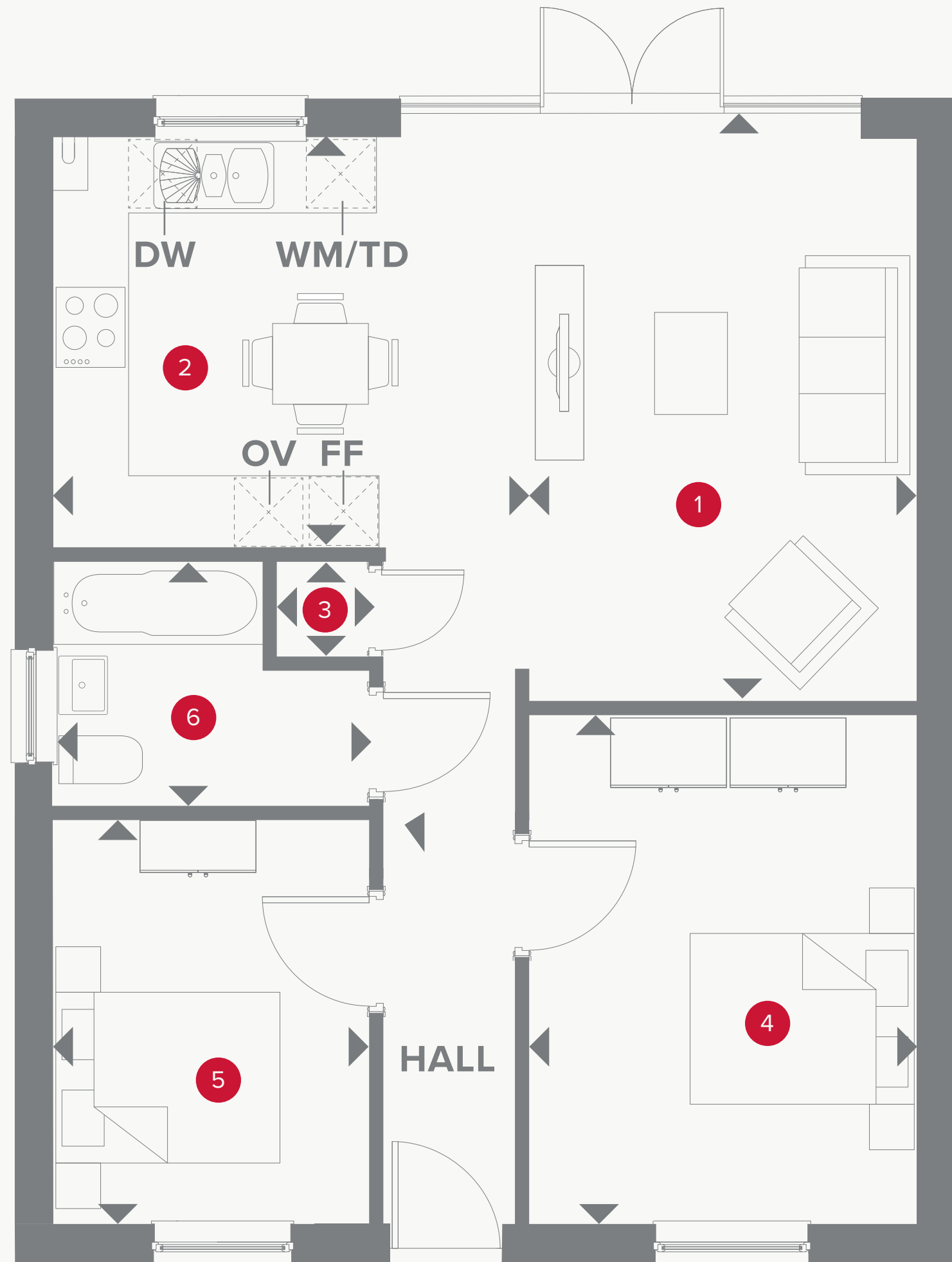

# THE BRADGATE GROUND FLOOR

1	Lounge	15'3" x 10'3"	4.65 x 3.12 m
2	Kitchen/ Dining	12'3" x 10'9"	3.74 x 3.33 m
3	Coats	2'6" x 2'5"	0.79 x 0.74 m
4	Bedroom 1	13'5" x 10'3"	4.11 x 3.12 m
5	Bedroom 2	10'7" x 8'4"	3.25 x 2.56 m
6	Bathroom	8'4" x 6'5"	2.56 x 1.97 m



**CONSUMER  
CODE FOR  
HOME BUILDERS**

[www.consumercode.co.uk](http://www.consumercode.co.uk)

Customers should note this illustration is an example of the Bradgate house type. All dimensions indicated are approximate and the furniture layout is for illustrative purposes only. Homes may be 'handed' (mirror image) versions of the illustrations, and may be detached, semi-detached or terraced. Materials used may differ from plot to plot including render and roof tile colours. Detailed plans and specifications are available for inspection for each plot at our Sales Centre during working hours and customers must check their individual specifications prior to making a reservation.

## KEY

Hob  
 Oven  
 Fridge/freezer

Tumble dryer space  
 Washing machine space  
 Dish washer space

Dimensions start