



TAILORED

- REDROW -

THE HOTON

TWO BEDROOM HOME



THE HOTON GROUND FLOOR

1 Garage

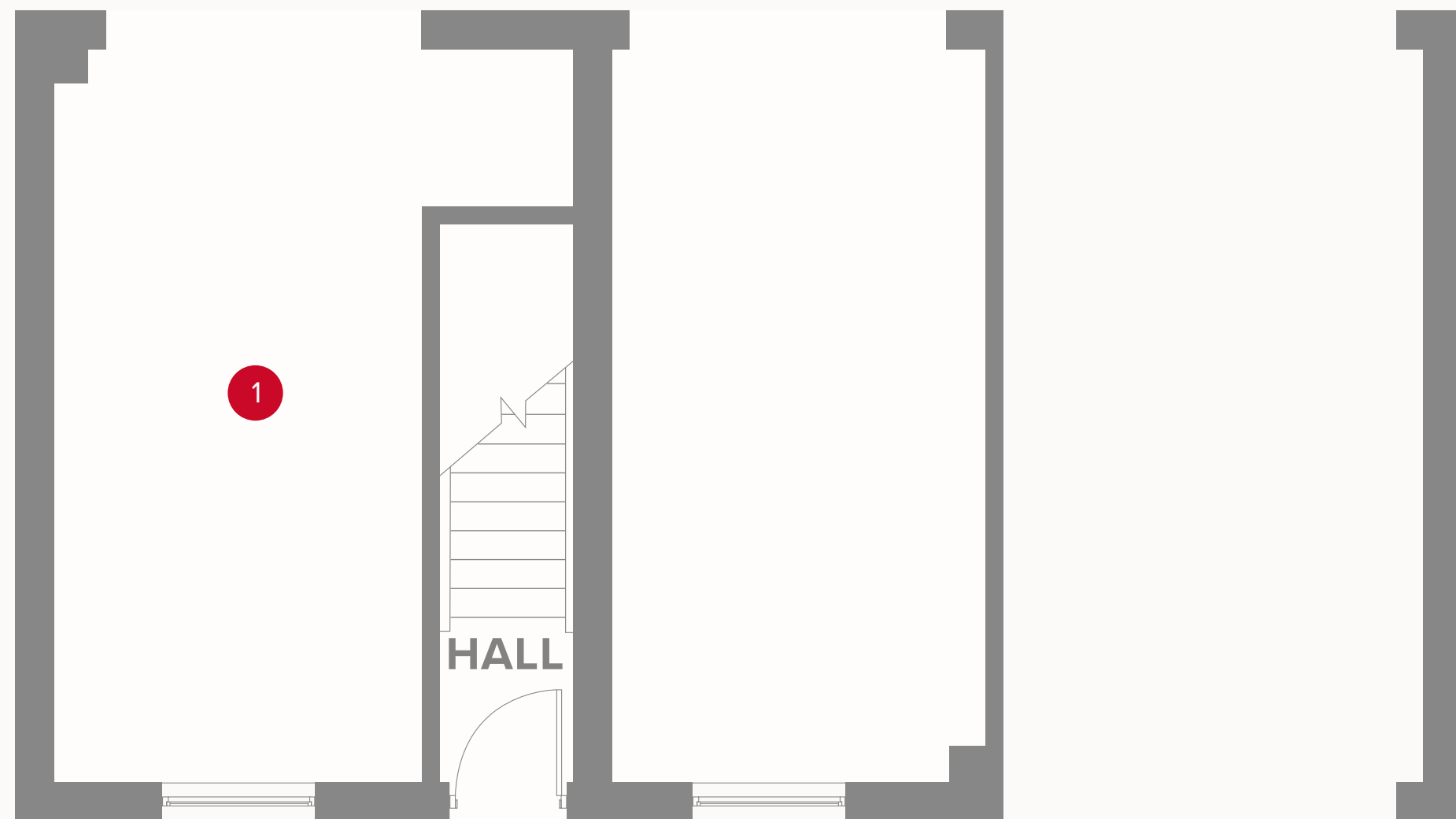

KEY

◀ Dimensions start

**CONSUMER
CODE FOR
HOME BUILDERS**
www.consumercode.co.uk

Customers should note this illustration is an example of the Hoton house type. All dimensions indicated are approximate and the furniture layout is for illustrative purposes only. Homes may be 'handed' (mirror image) versions of the illustrations, and may be detached, semi-detached or terraced. Materials used may differ from plot to plot including render and roof tile colours. Detailed plans and specifications are available for inspection for each plot at our Sales Centre during working hours and customers must check their individual specifications prior to making a reservation.

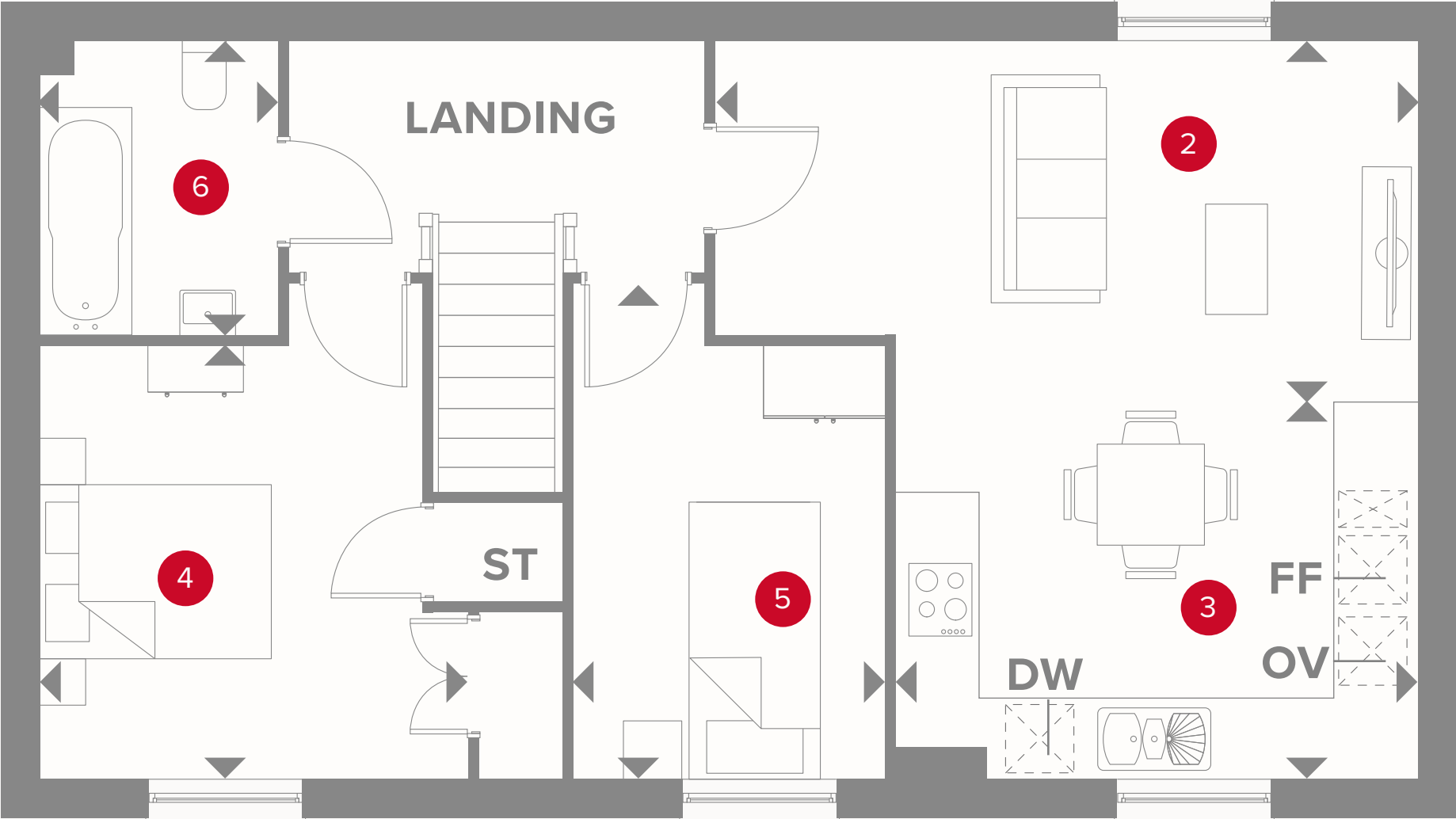

THE HOTON FIRST FLOOR

2	Lounge	17' x 11'2"	5.19 x 3.40 m
3	Kitchen/Dining	12'6" x 6'6"	3.84 x 2.00 m
4	Bedroom 1	9'4" x 12'1"	2.85 x 3.67 m
5	Bedroom 2	7'7" x 12'1"	2.35 x 3.67 m
6	Bathroom	5'8" x 7'2"	1.78 x 2.20 m



KEY

- Hob
- Fridge/freezer
- Dimensions start

- Storage cupboard
- Dish washer space