



HERITAGE

- REDROW -

THE CANTERBURY LIFESTYLE

THREE BEDROOM HOME

 **REDROW**

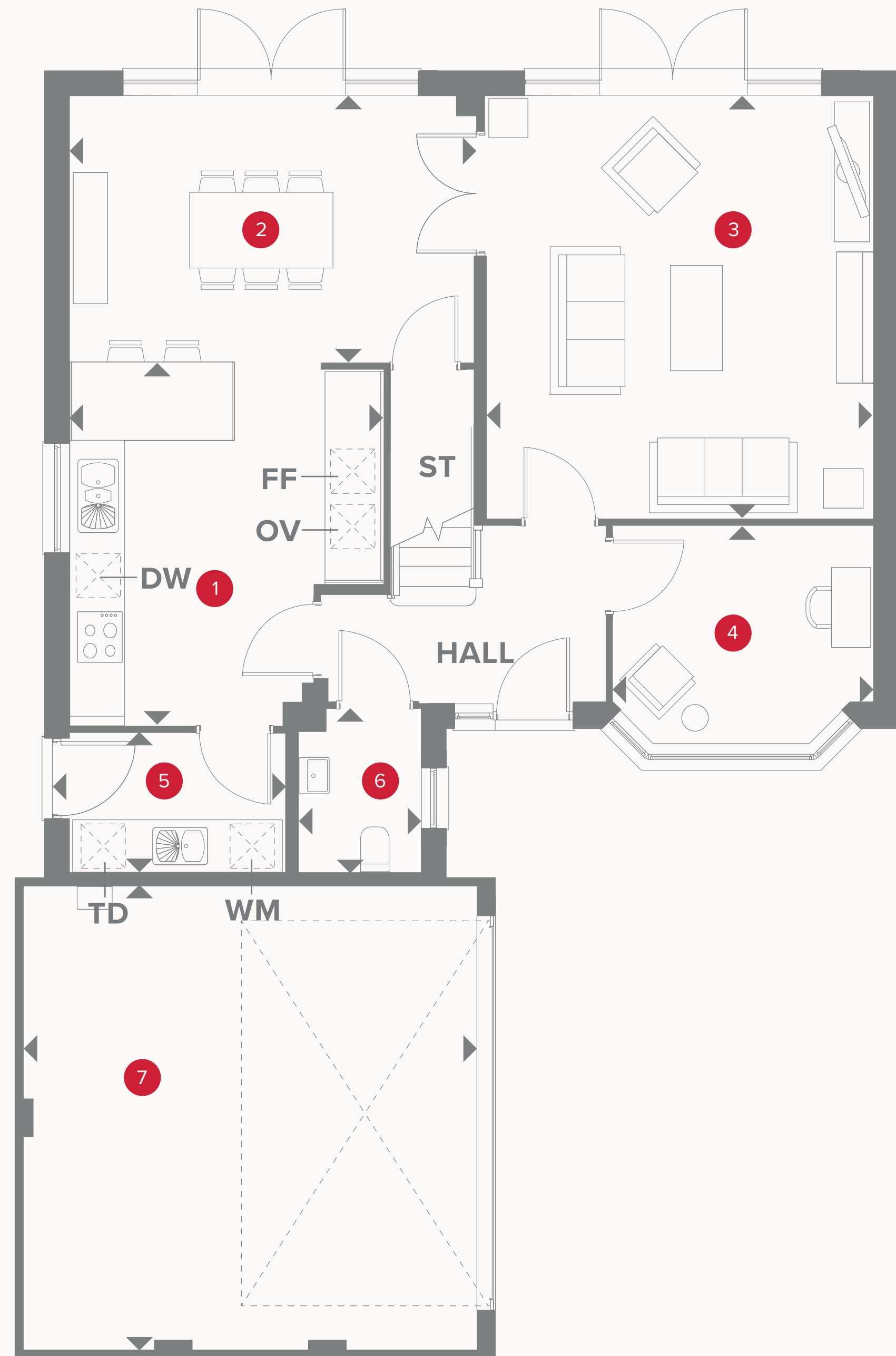



THE CANTERBURY LIFESTYLE GROUND FLOOR

1	Kitchen	13'8" x 11'9"	4.16 x 3.59m
2	Dining	15'2" x 10'0"	4.63 x 3.04m
3	Lounge	15'10" x 14'6"	4.82 x 4.42m
4	Study	9'9" x 8'1"	2.98 x 2.47m
5	Utility	8'0" x 5'5"	2.44 x 1.65m
6	Cloaks	6'4" x 4'8"	1.93 x 1.43m
7	Garage	17'5" x 17'0"	5.30 x 5.19m



KEY

 Hob
OV Oven
FF Fridge/freezer
TD Tumble dryer space

 Dimensions start
ST Storage cupboard
WM Washing machine space
DW Dish washer space

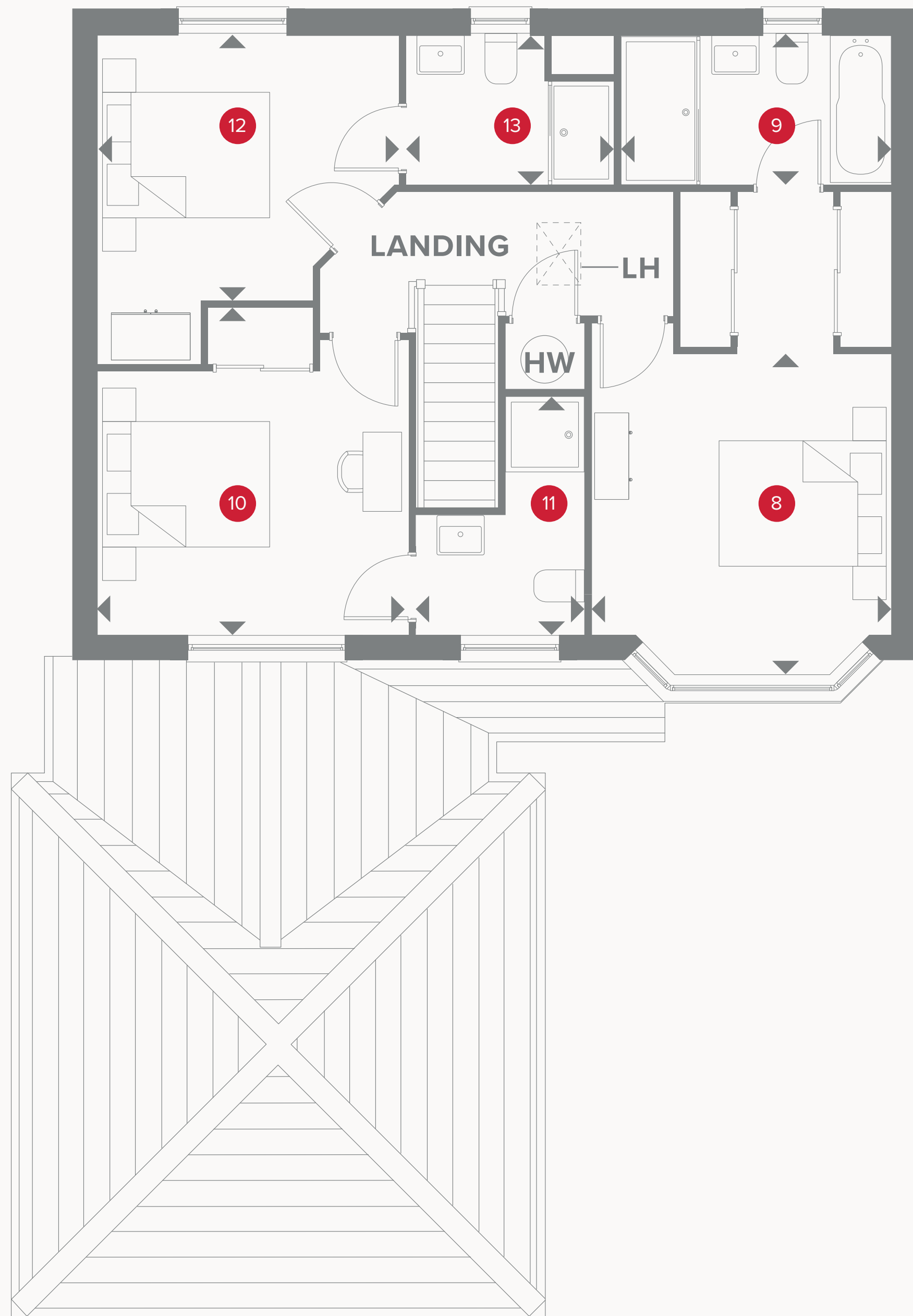

THE CANTERBURY LIFESTYLE FIRST FLOOR

8	Bedroom 1	18'4" x 11'5"	5.59 x 3.48m
9	En-suite 1	10'0" x 5'9"	3.05 x 1.74m
10	Bedroom 2	12'5" x 11'8"	3.78 x 3.56m
11	En-suite 2	9'0" x 6'5"	2.75 x 1.95m
12	Bedroom 3	12'6" x 12'2"	3.82 x 3.71m
13	En-suite 3	7'7" x 5'9"	2.31 x 1.74m



KEY

- ◀ Dimensions start
- HW** Hot water storage
- LH** Loft hatch

**CONSUMER
CODE FOR
HOME BUILDERS**
www.consumercode.co.uk

Customers should note this illustration is an example of the Canterbury Lifestyle house type. All dimensions indicated are approximate and the furniture layout is for illustrative purposes only. Homes may be 'handed' (mirror image) versions of the illustrations, and may be detached, semi-detached or terraced. Materials used may differ from plot to plot including render and roof tile colours. Detailed plans and specifications are available for inspection for each plot at our Sales Centre during working hours and customers must check their individual specifications prior to making a reservation.