



**HERITAGE**

- REDROW -

# THE BALMORAL

FOUR BEDROOM DETACHED HOME





# THE BALMORAL GROUND FLOOR

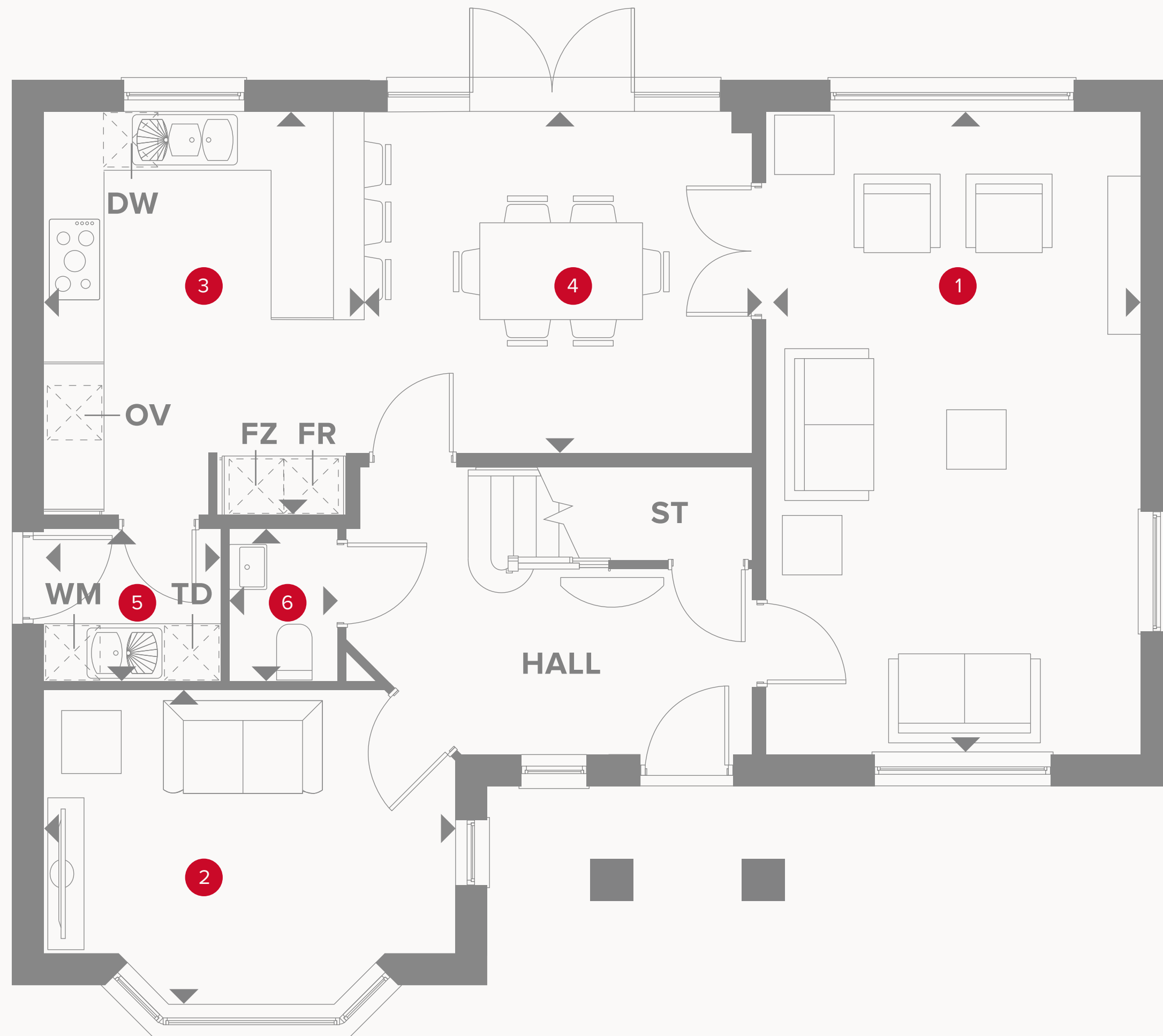

1	Lounge	12'5" x 21'6"	3.80 x 6.56 m
2	Family room	13'8" x 10'4"	4.19 x 3.16 m
3	Kitchen	10'6" x 13'5"	3.21 x 4.11 m
4	Dining	13'1" x 11'5"	3.99 x 3.49 m
5	Utility	5'10" x 5'0"	1.80 x 1.54 m
6	Cloaks	3'7" x 5'0"	1.10 x 1.54 m



## KEY

 Hob  
**OV** Oven  
**FR** Fridge  
**FZ** Freezer

 Dimensions start  
**TD** Tumble dryer space  
**WM** Washing machine space  
**DW** Dishwasher space

**ST** Storage cupboard



# THE BALMORAL FIRST FLOOR

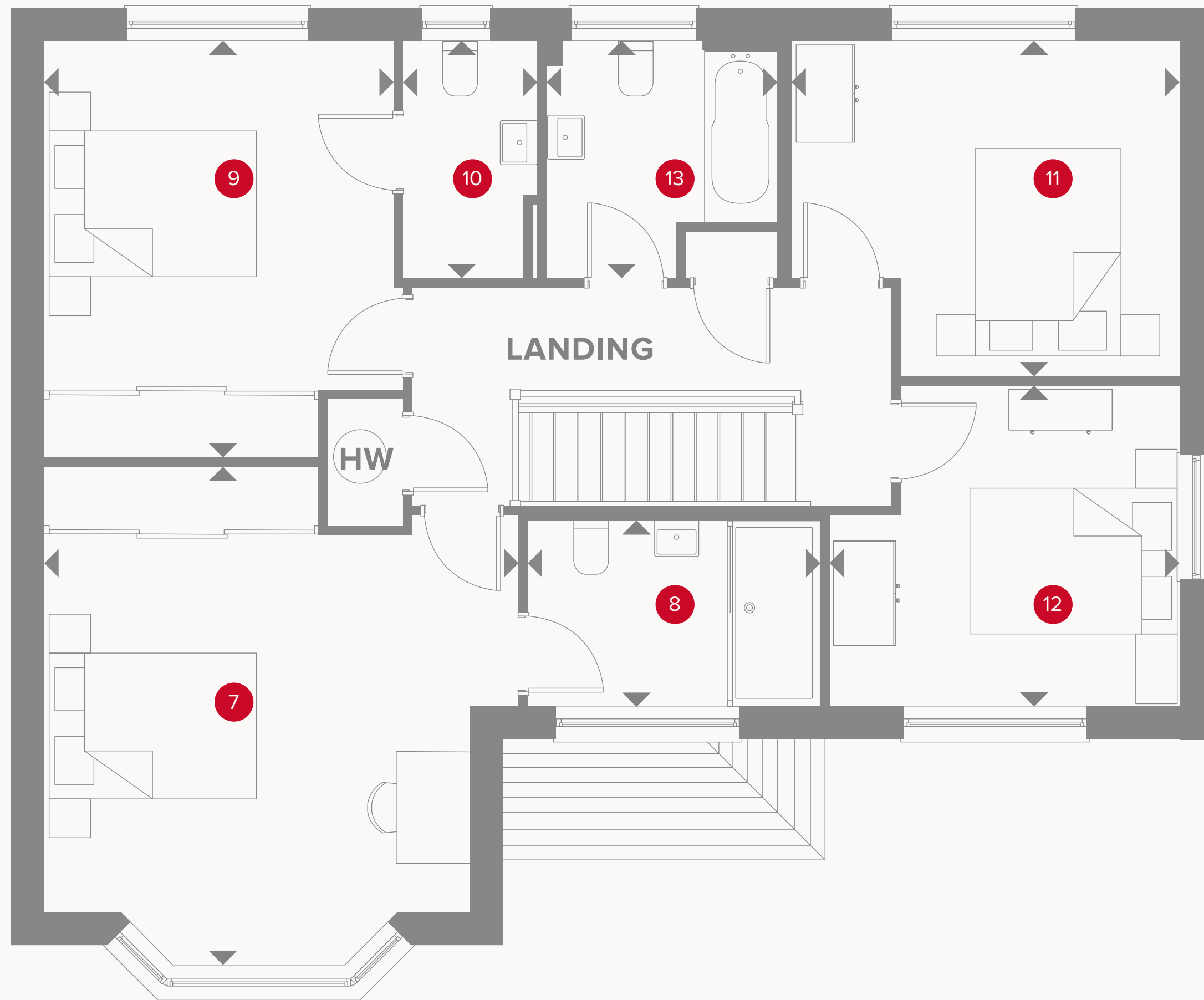

7	Bedroom 1	15'3" x 14'7"	4.67 x 4.86 m
8	En-suite 1	9'5" x 5'10"	2.87 x 1.80 m
9	Bedroom 2	11'3" x 13'5"	3.45 x 4.10 m
10	En-suite 2	7'5" x 7'7"	2.28 x 2.33 m
11	Bedroom 3	12'6" x 10'9"	3.83 x 3.30 m
12	Bedroom 4	11'3" x 10'4"	3.44 x 3.16 m
13	Bathroom	7'5" x 7'7"	2.28 x 2.33 m



**CONSUMER  
CODE FOR  
HOME BUILDERS**  
[www.consumercode.co.uk](http://www.consumercode.co.uk)

Customers should note this illustration is an example of the Balmoral house type. All dimensions indicated are approximate and the furniture layout is for illustrative purposes only. Homes may be 'handed' (mirror image) versions of the illustrations, and may be detached, semi-detached or terraced. Materials used may differ from plot to plot including render and roof tile colours. Detailed plans and specifications are available for inspection for each plot at our Customer Experience Suites during working hours and customers must check their individual specifications prior to making a reservation. Computer generated images are for indicative purposes only.

## KEY

◀ Dimensions start  
**HW** Hot water cylinder