

Willow

One bedroom home



Where you
want to be

Harwood
Homes

Willow

One bedroom home

The Willow is a wonderful one bedroom home benefiting from the modern touch. The open plan kitchen/dining and lounge area acts as the heart of the home, together with the master bedroom and family bathroom.

Ground floor

Lounge/ Kitchen	17'7" x 14'10"	5.35 x 4.53 m
Laundry	2'10" x 2'3"	0.87 x 0.68 m
Bedroom	13'0" x 10'4"	3.96 x 3.15 m
Bathroom	6'10" x 5'9"	2.09 x 1.76 m

Customers should note this illustration is an example of the Willow house type. All dimensions indicated are approximate and furniture layout is for illustrative purposes only. Detailed plans and specifications are available for inspection for each plot at our Sales Centre during working hours and customers must check their individual specifications prior to making a reservation.

Harwoodhomes.co.uk give notice that the property particulars and related information on this site, whilst believed to be accurate, are set as a general outline for guidance only. Intending purchasers should not rely on them as statements or representations of fact, but must satisfy themselves before physical inspection as to their availability, or by physical inspection of the property in question or otherwise as to their accuracy or fit for purpose. Consequently, no information displayed on this site (or linked sites) constitutes or forms part of a contract. Materials used may differ from plot to plot including render and roof tile colours.

KEY

	Hob
ov	Oven
ff	Fridge/freezer
dw	Dishwasher

*Max dimensions Note: Bedroom dimensions taken into wardrobe recess. All wardrobes are subject to site specification. Please see Sales Consultant for further details. Harwood Homes is a trading name of Redrow Homes Ltd.

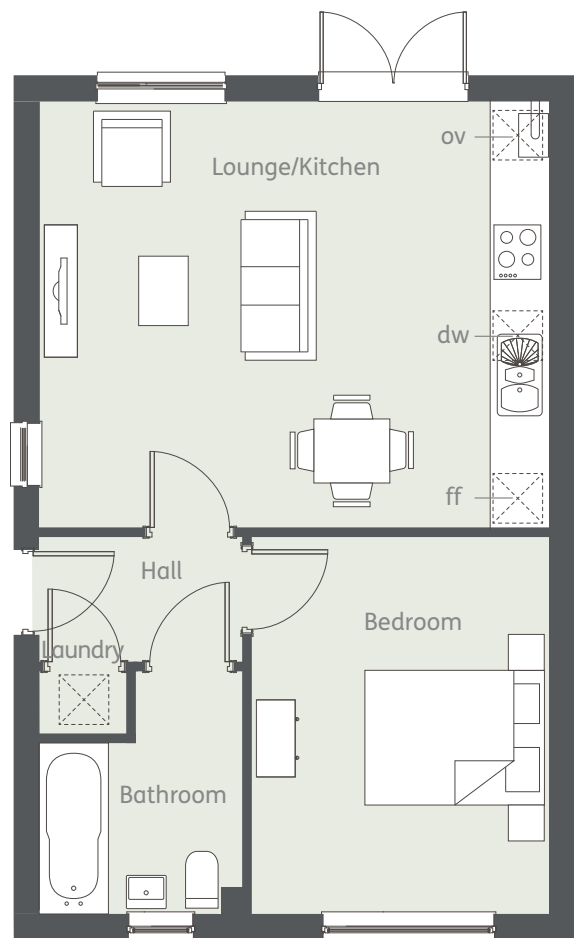

Discover where you want to be and visit
harwoodhomes.co.uk

Harwood
Homes