

**GROUND FLOOR**

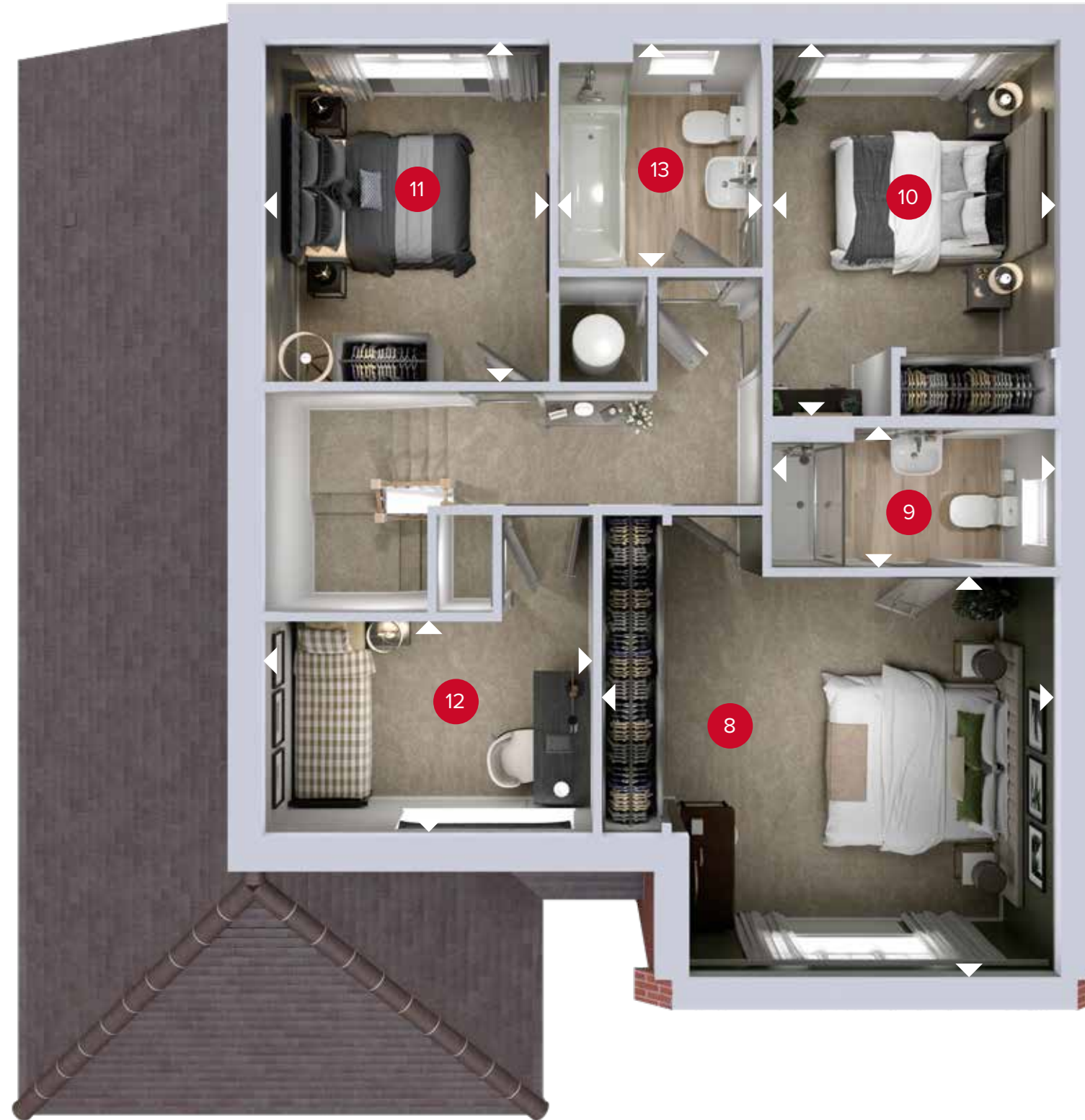

**FIRST FLOOR**

# THE WELWYN

## GROUND FLOOR

1	Lounge	16'0" x 11'8"	4.88 x 3.56 m
2	Kitchen	12'3" x 10'9"	3.74 x 3.27 m
3	Dining	11'8" x 11'1"	3.55 x 3.37 m
4	Family	13'8" x 11'6"	4.16 x 3.50 m
5	Utility	7'3" x 6'0"	2.21 x 1.83 m
6	Cloaks	5'1" x 3'7"	1.54 x 1.08 m
7	Garage	17'0" x 15'10"	5.17 x 4.82 m

## FIRST FLOOR

8	Bedroom 1	14'7" x 12'8"	4.44 x 3.86 m
9	En-suite	9'2" x 4'6"	2.79 x 1.36 m
10	Bedroom 2	12'4" x 9'2"	3.77 x 2.79 m
11	Bedroom 3	11'3" x 9'1"	3.43 x 2.78 m
12	Bedroom 4	10'6" x 6'11"	3.20 x 2.10 m
13	Bathroom	7'7" x 6'6"	2.32 x 1.98 m



13.03.2022

Customers should note this illustration is an example of the Welwyn house type. All dimensions indicated are approximate and the furniture layout is for illustrative purposes only. Homes may be 'handed' (mirror image) versions of the illustrations, and may be detached, semi-detached or terraced. Materials used may differ from plot to plot including render and roof tile colours. Detailed plans and specifications are available for inspection for each plot at our Customer Experience Suite or Sales Centre during working hours and customers must check their individual specifications prior to making a reservation. Please note that the specification show in this plan may include optional upgrades from standard specification. Please speak with your Sales Consultant or visit MyRedrow for more information. EG\_WELW\_DM.2

▷ Denotes where dimensions are taken from. All wardrobes are subject to site specification. Please see Sales Consultant for further details.

ov - oven  
ff - fridge freezer  
dw - dishwasher space

wm - washing machine space  
td - tumble dryer space

