



HERITAGE

- REDROW -

THE SANDRINGHAM PREMIUM

FIVE BEDROOM HOME





HERITAGE

- REDROW -

THE SANDRINGHAM PREMIUM

FIVE BEDROOM HOME



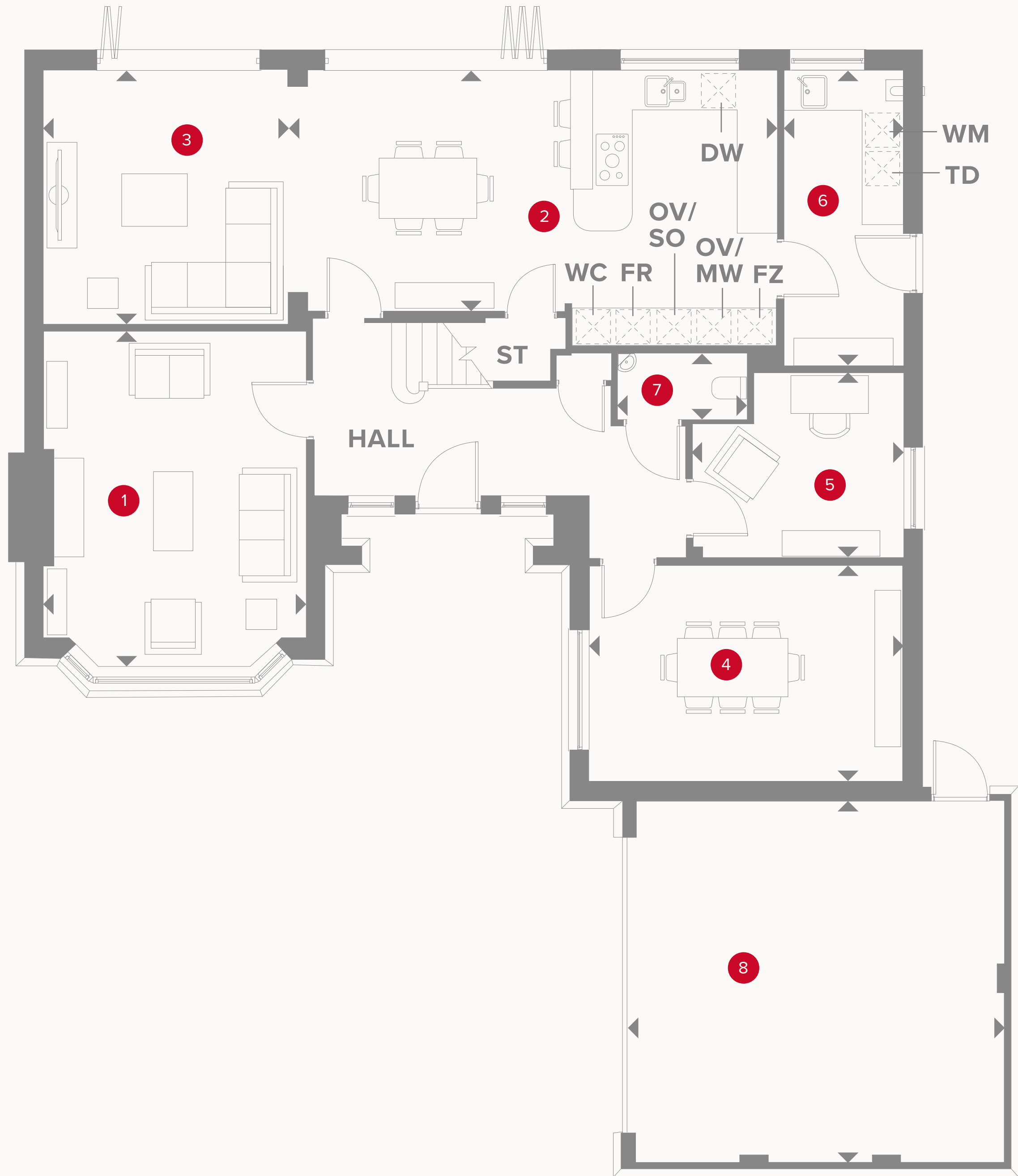

THE SANDRINGHAM PREMIUM **GROUND FLOOR**

1	Lounge	16'10" x 13'0"	5.12 x 3.97 m
2	Kitchen	23'5" x 13'9"	7.15 x 4.19 m
3	Family	12'8" x 12'2"	3.85 x 3.70 m
4	Dining	15'7" x 10'8"	4.75 x 3.26 m
5	Study	10'6" x 9'3"	3.20 x 2.83 m
6	Utility/Boot Room	14'10" x 5'10"	4.51 x 1.78 m
7	Cloaks	6'7" x 3'3"	2.00 x 0.99 m
8	Garage	18'4" x 18'1"	5.58 x 5.52 m



KEY

- | | | |
|-------------------|---------------------------------|----------------------------|
| Hob | Dimensions start | ST Storage cupboard |
| OV Oven | TD Tumble dryer space | WC Wine cooler |
| FR Fridge | WM Washing machine space | MW Microwave |
| FZ Freezer | DW Dishwasher space | SO Steam Oven |

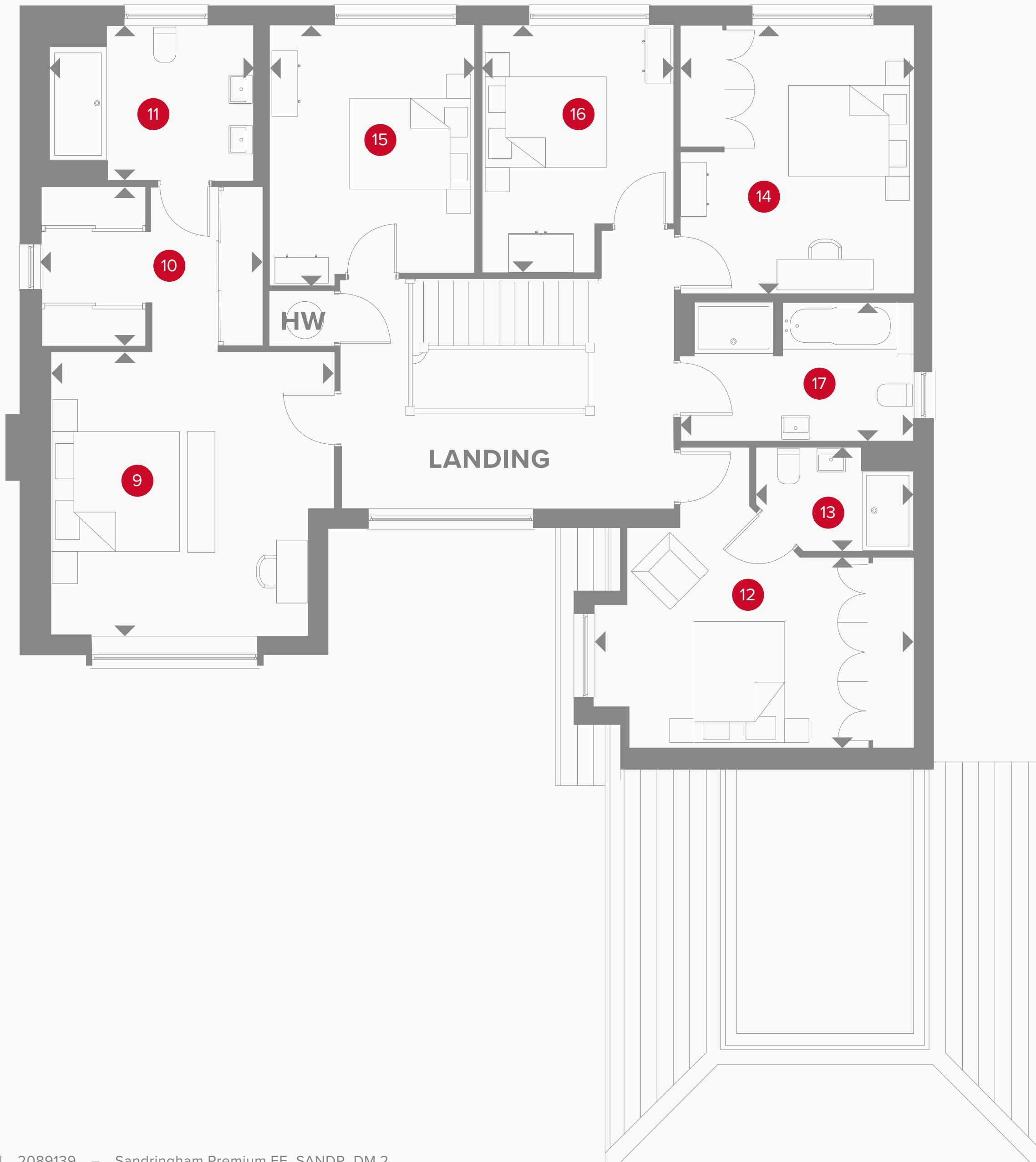

THE SANDRINGHAM PREMIUM **FIRST FLOOR**

9	Bedroom 1	14'5" x 13'11"	4.39 x 4.23 m
10	Dressing	10'10" x 7'10"	3.31 x 2.39 m
11	En-suite	10'0" x 7'7"	3.06 x 2.32 m
12	Bedroom 2	15'7" x 14'9"	4.76 x 4.50 m
13	En-suite 2	7'9" x 5'1"	2.35 x 1.56 m
14	Bedroom 3	13'3" x 11'5"	4.03 x 3.48 m
15	Bedroom 4	12'9" x 10'2"	3.89 x 3.10 m
16	Bedroom 5	12'2" x 9'6"	3.71 x 2.90 m
17	Bathroom	11'5" x 6'11"	3.48 x 2.10 m



KEY

- ◀ Dimensions start
- HW Hot water storage

**CONSUMER
CODE FOR
HOME BUILDERS**
www.consumercode.co.uk

Customers should note this illustration is an example of the Sandringham house type. All dimensions indicated are approximate and the furniture layout is for illustrative purposes only. Homes may be 'handed' (mirror image) versions of the illustrations, and may be detached, semi-detached or terraced. Materials used may differ from plot to plot including render and roof tile colours. Detailed plans and specifications are available for inspection for each plot at our Sales Centre during working hours and customers must check their individual specifications prior to making a reservation.