



INSPIRED

- REDROW -

THE DANE

FOUR BEDROOM HOME

 **REDROW**



INSPIRED

- REDROW -

THE DANE

FOUR BEDROOM HOME

 **REDROW**

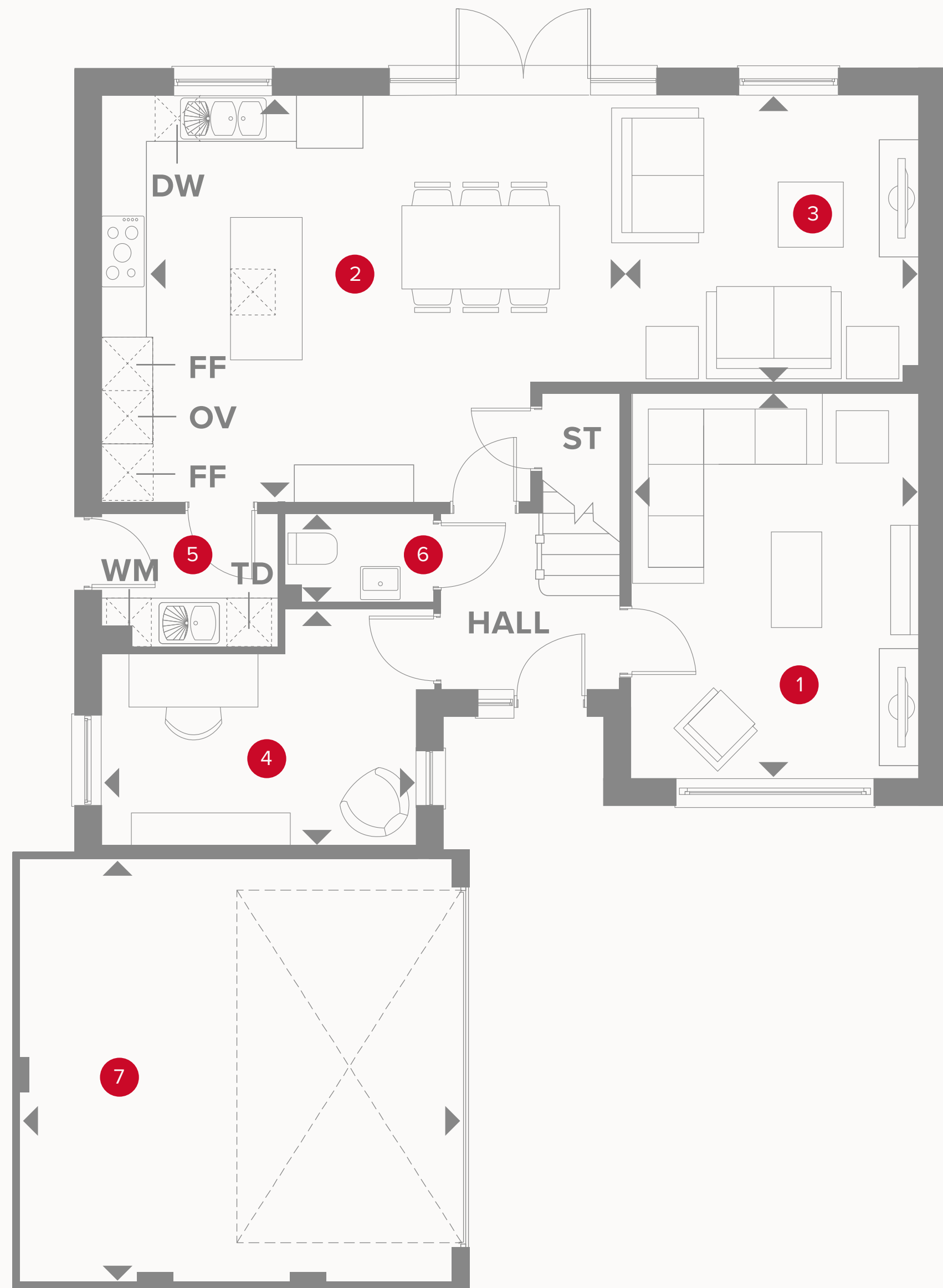

THE DANE GROUND FLOOR

1 Lounge	15'10" x 11'10"	4.84 x 3.63m
2 Kitchen/Dining	19'11" x 16'8"	6.08 x 5.10m
3 Family	13'9" x 11'9"	4.19 x 3.60m
4 Study	13'0" x 9'8"	3.97 x 2.97m
5 Utility	7'3" x 5'5"	2.22 x 1.66m
6 Cloaks	6'0" x 3'7"	1.85 x 1.10m
7 Garage	17'9" x 17'4"	5.41 x 5.29m



KEY

- Hob
- OV** Oven
- FF** Fridge/freezer
- TD** Tumble dryer space

- Dimensions start
- ST** Storage cupboard
- WM** Washing machine space
- DW** Dish washer space

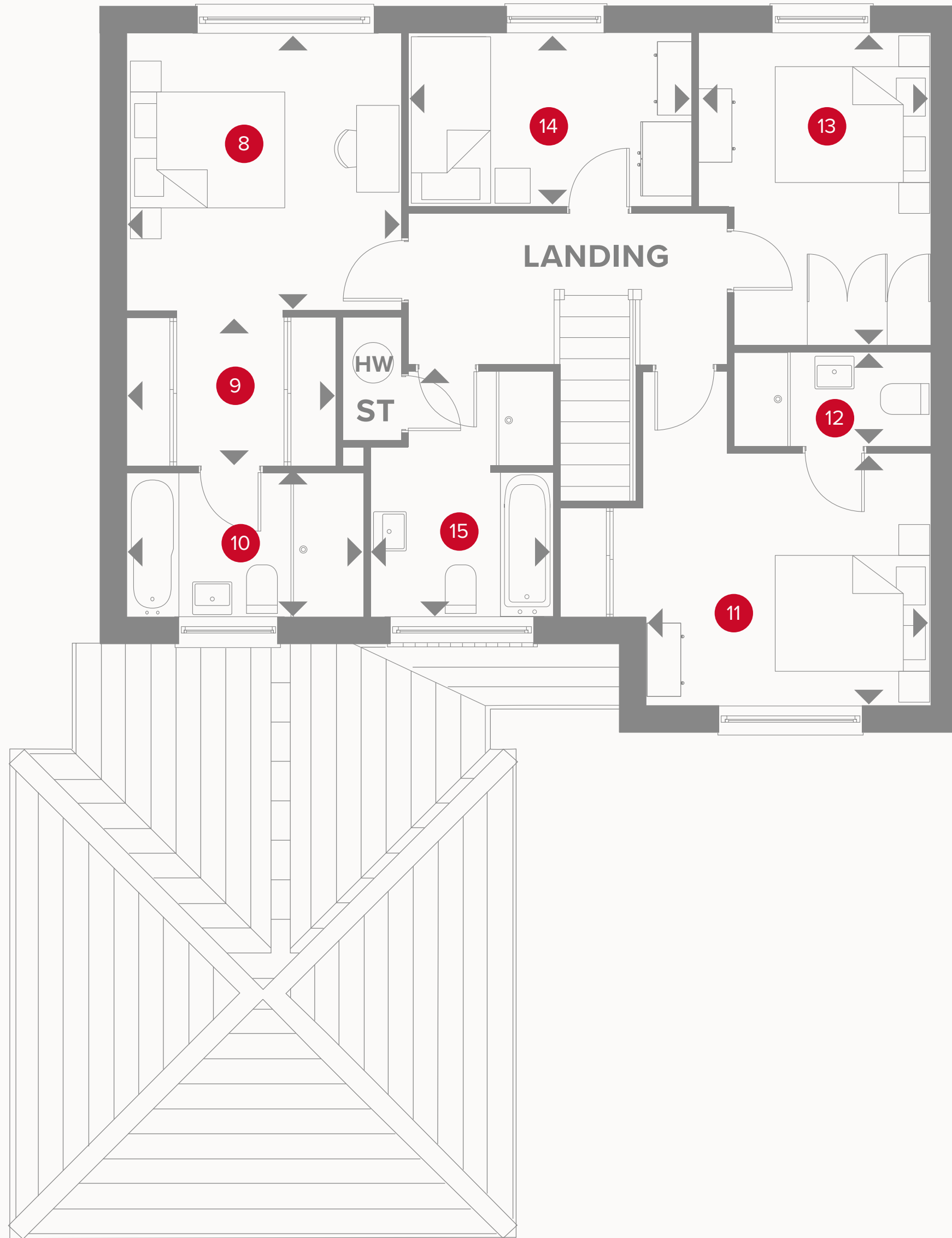

THE DANE FIRST FLOOR

8	Bedroom 1	11'7" x 11'6"	3.55 x 3.52m
9	Dressing	8'10" x 6'2"	2.68 x 1.88m
10	En-suite 1	9'11" x 6'1"	3.03 x 1.86m
11	Bedroom 2	15'6" x 10'6"	4.73 x 3.22m
12	En-suite 2	8'3" x 3'10"	2.53 x 1.18m
13	Bedroom 3	13'1" x 9'8"	3.99 x 2.96m
14	Bedroom 4	11'7" x 7'3"	3.55 x 2.23m
15	Bathroom	10'3" x 7'7"	3.13 x 2.33m



KEY

- ◀ Dimensions start
- HW Hot water storage

**CONSUMER
CODE FOR
HOME BUILDERS**

www.consumercode.co.uk

Customers should note this illustration is an example of the Dane house type. All dimensions indicated are approximate and the furniture layout is for illustrative purposes only. Homes may be 'handed' (mirror image) versions of the illustrations, and may be detached, semi-detached or terraced. Materials used may differ from plot to plot including render and roof tile colours. Detailed plans and specifications are available for inspection for each plot at our Sales Centre during working hours and customers must check their individual specifications prior to making a reservation.