



INSPIRED

- REDROW -

# THE PICKMERE

FOUR BEDROOM HOME





# THE PICKMERE GROUND FLOOR

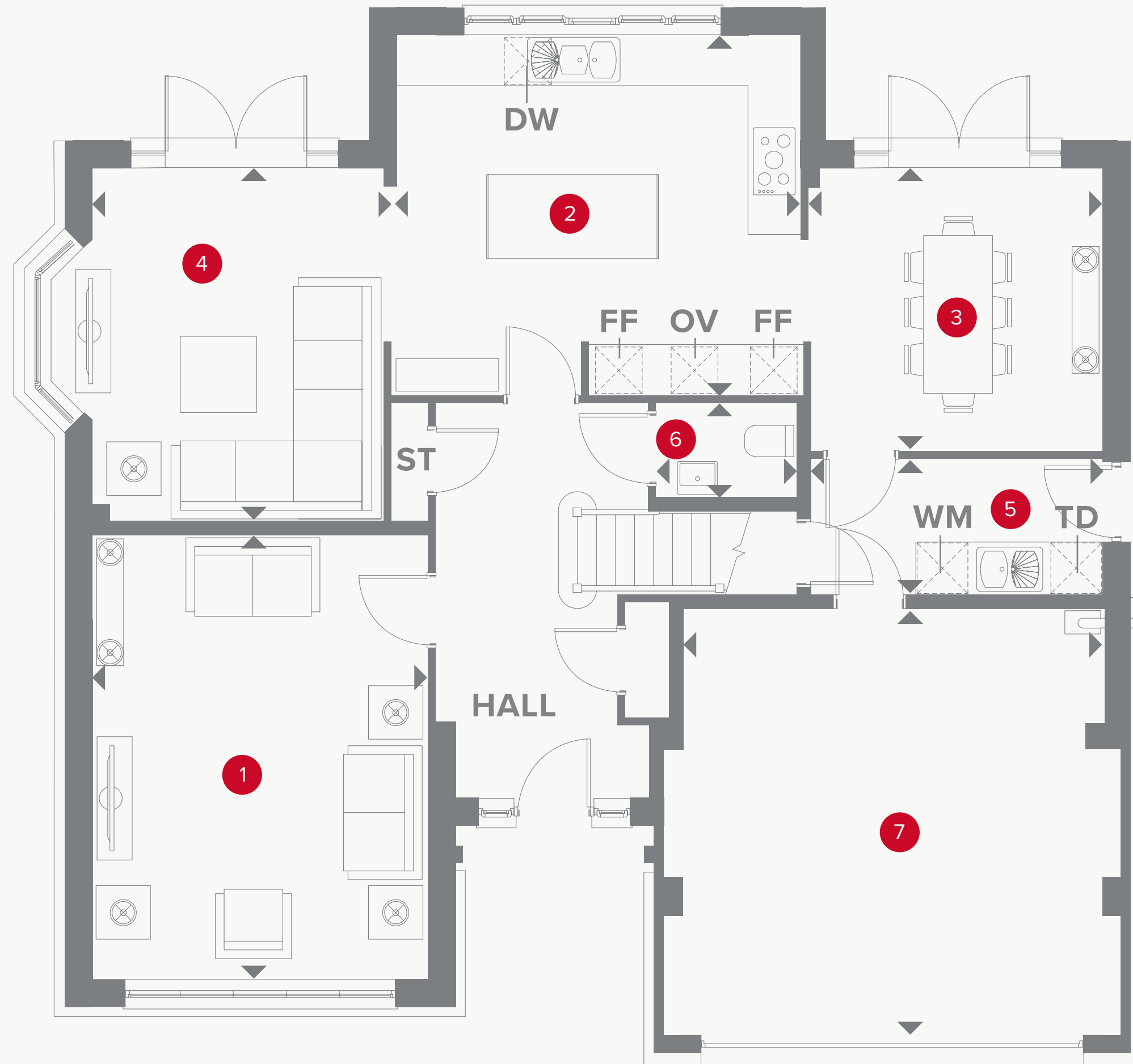

1	Lounge	17'2" x 13'0"	5.24 x 3.96 m
2	Kitchen	15'5" x 13'9"	4.75 x 4.24 m
3	Dining	11'3" x 10'9"	3.45 x 3.34 m
4	Family	13'7" x 11'3"	4.19 x 3.45 m
5	Utility	11'3" x 5'3"	3.45 x 1.61 m
6	Cloaks	5'4" x 3'7"	1.67 x 1.12 m
7	Garage	17'1" x 16'4"	5.20 x 4.99 m



## KEY

- Hob
- OV** Oven
- FF** Fridge/freezer
- TD** Tumble dryer space

- Dimensions start
- ST** Storage cupboard
- WM** Washing machine space
- DW** Dish washer space

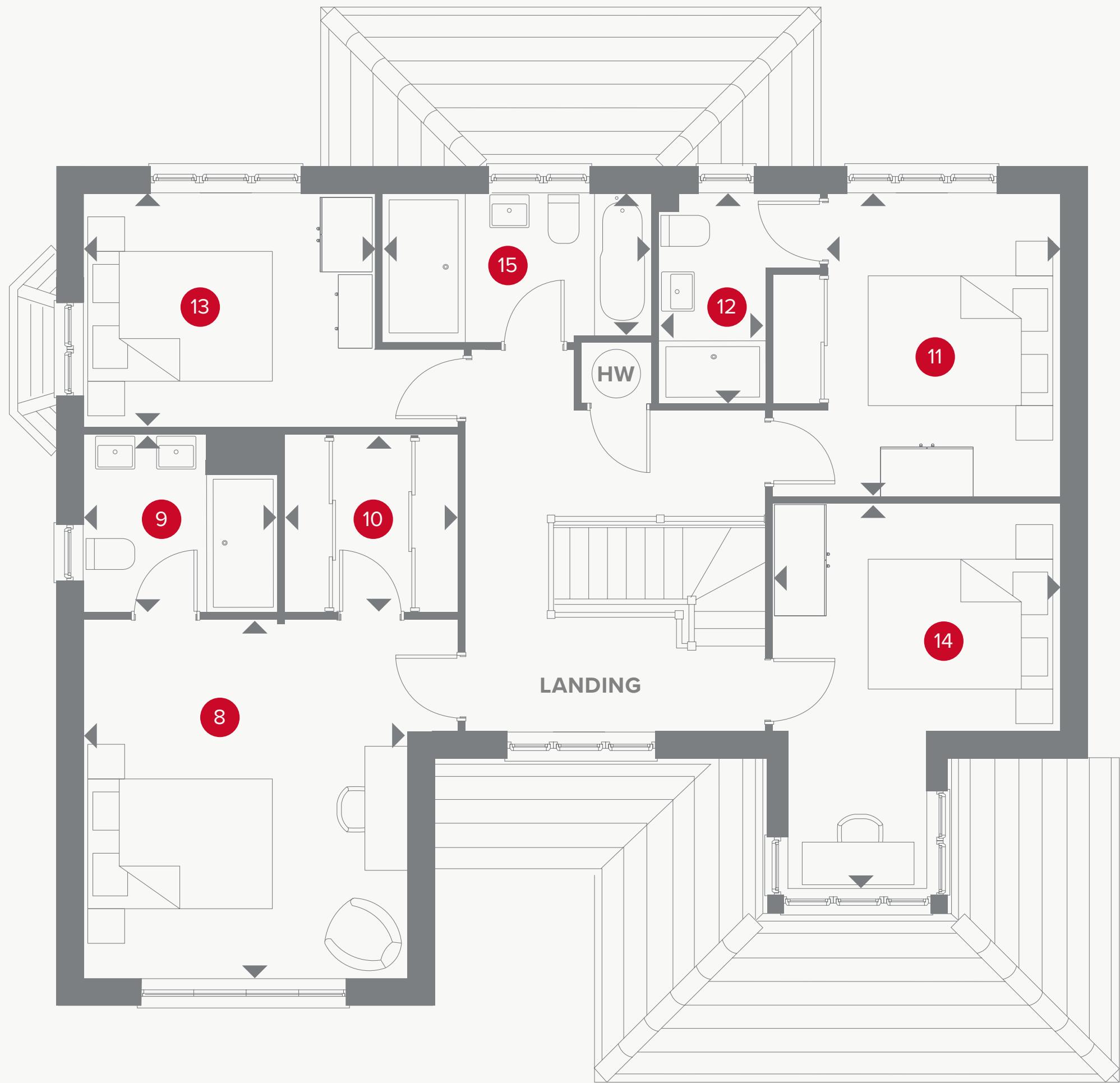

# THE PICKMERE FIRST FLOOR

8	Bedroom 1	14'3" x 13'0"	4.36 x 3.96 m
9	En-suite 1	7'8" x 7'1"	2.39 x 2.17 m
10	Wardrobe	6'8" x 7'1"	2.07 x 2.17 m
11	Bedroom 2	12'0" x 11'5"	3.67 x 3.52 m
12	En-suite 2	8'4" x 4'2"	2.57 x 1.27 m
13	Bedroom 3	11'7" x 9'3"	3.57 x 2.84 m
14	Bedroom 4	15'4" x 11'5"	4.72 x 3.52 m
15	Bathroom	10'8" x 5'8"	3.28 x 1.75 m

