



HERITAGE

- REDROW -

THE PORTMAN

FOUR BEDROOM END-TERRACED HOME

 **REDROW**



HERITAGE

- REDROW -

THE PORTMAN

FOUR BEDROOM END-TERRACED HOME

 **REDROW**

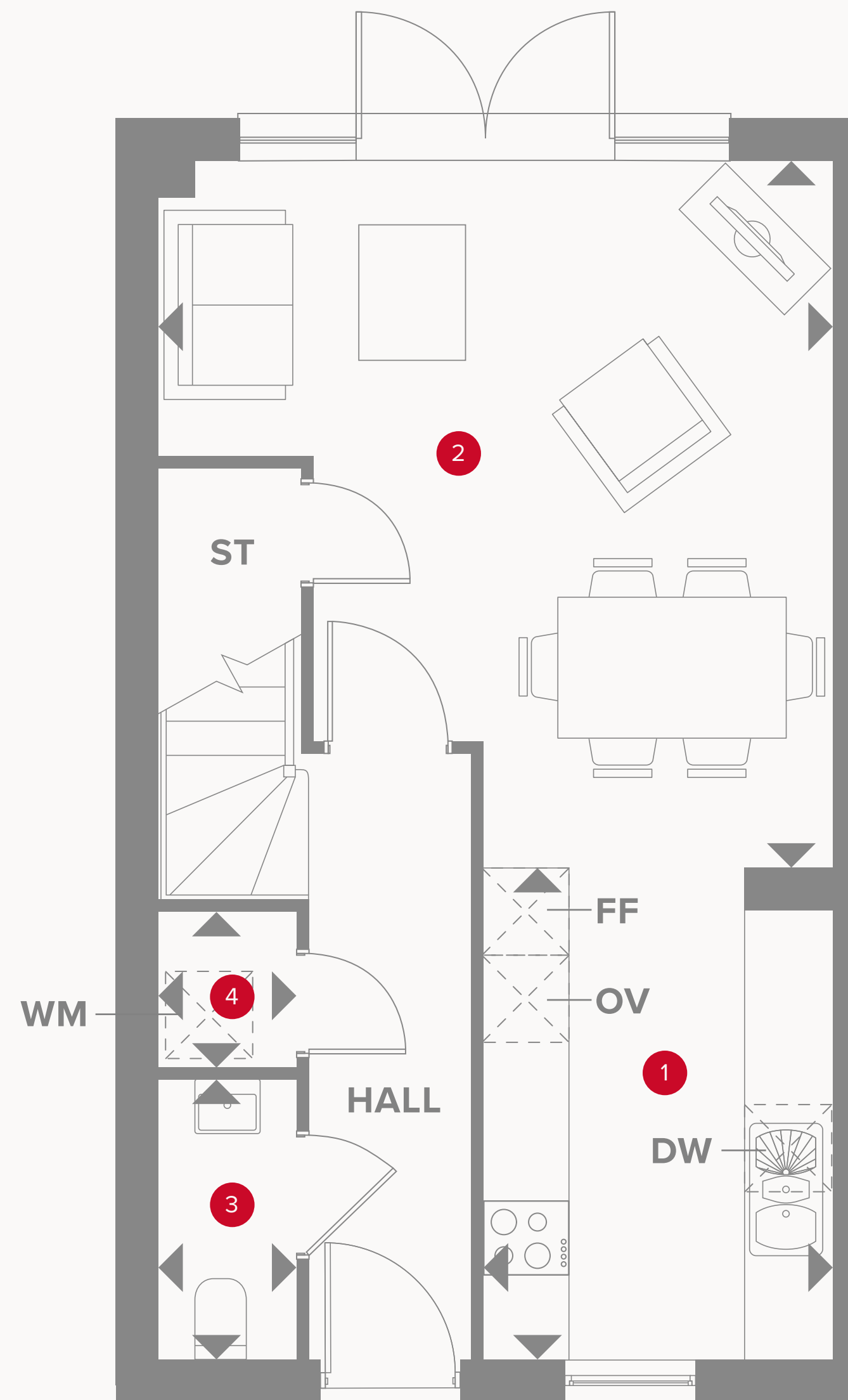



THE PORTMAN GROUND FLOOR

1 Kitchen	11'2" x 8'0"	3.41 x 2.45 m
2 Lounge/Dining	15'11" x 15'3"	4.84 x 4.65 m
3 Cloaks	6'4" x 3'1"	1.93 x 0.94 m
4 Laundry	3'3" x 3'1"	1.00 x 0.94 m



KEY

-  Hob
- OV** Oven
- FF** Fridge/freezer
-  Dimensions start

- ST** Storage cupboard
- WM** Washing machine space
- DW** Dish washer space

THE PORTMAN FIRST FLOOR

5	Lounge	15'3" x 9'11"	4.65 x 3.02 m
6	Bedroom 1	13'10" x 8'4"	4.22 x 2.55 m
7	En-suite 1	6'7" x 6'4"	2.01 x 1.93 m

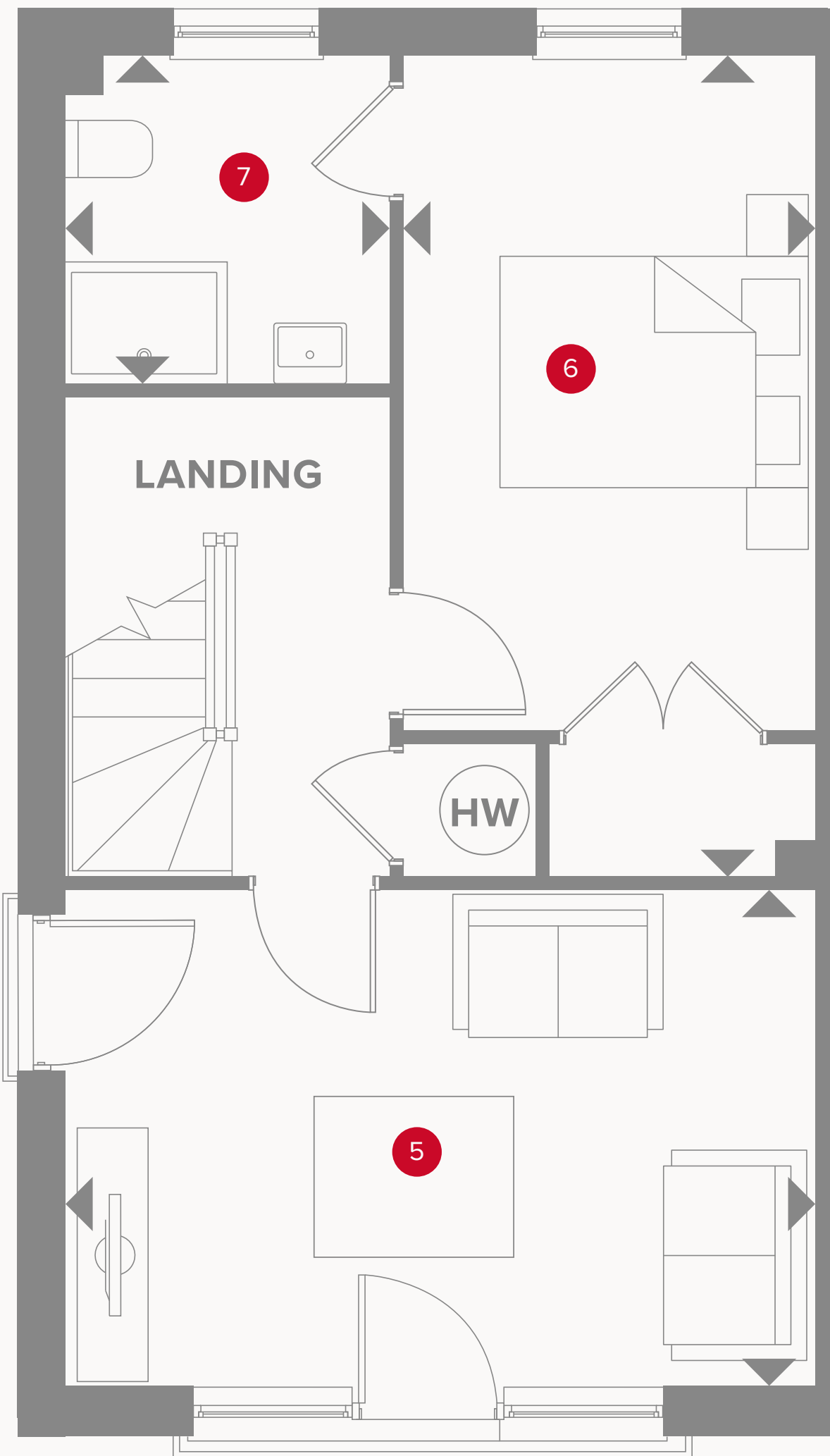

Plots 290 and 294 with additional windows only.



KEY

- ◀ Dimensions start
- ST Storage cupboard
- HW Hot water cylinder

THE PORTMAN SECOND FLOOR

8	Bedroom 2	13'1" x 8'2"	3.99 x 2.50 m
9	Ensuite 2	8'2" x 5'7"	2.50 x 1.70 m
10	Bedroom 3	9'10" x 7'9"	3.00 x 2.35 m
11	Bedroom 4/Study	9'11" x 6'9"	3.02 x 2.06 m
12	Bathroom	7'3" x 6'8"	2.21 x 2.03 m



Plots 290 and 294 with additional windows only.

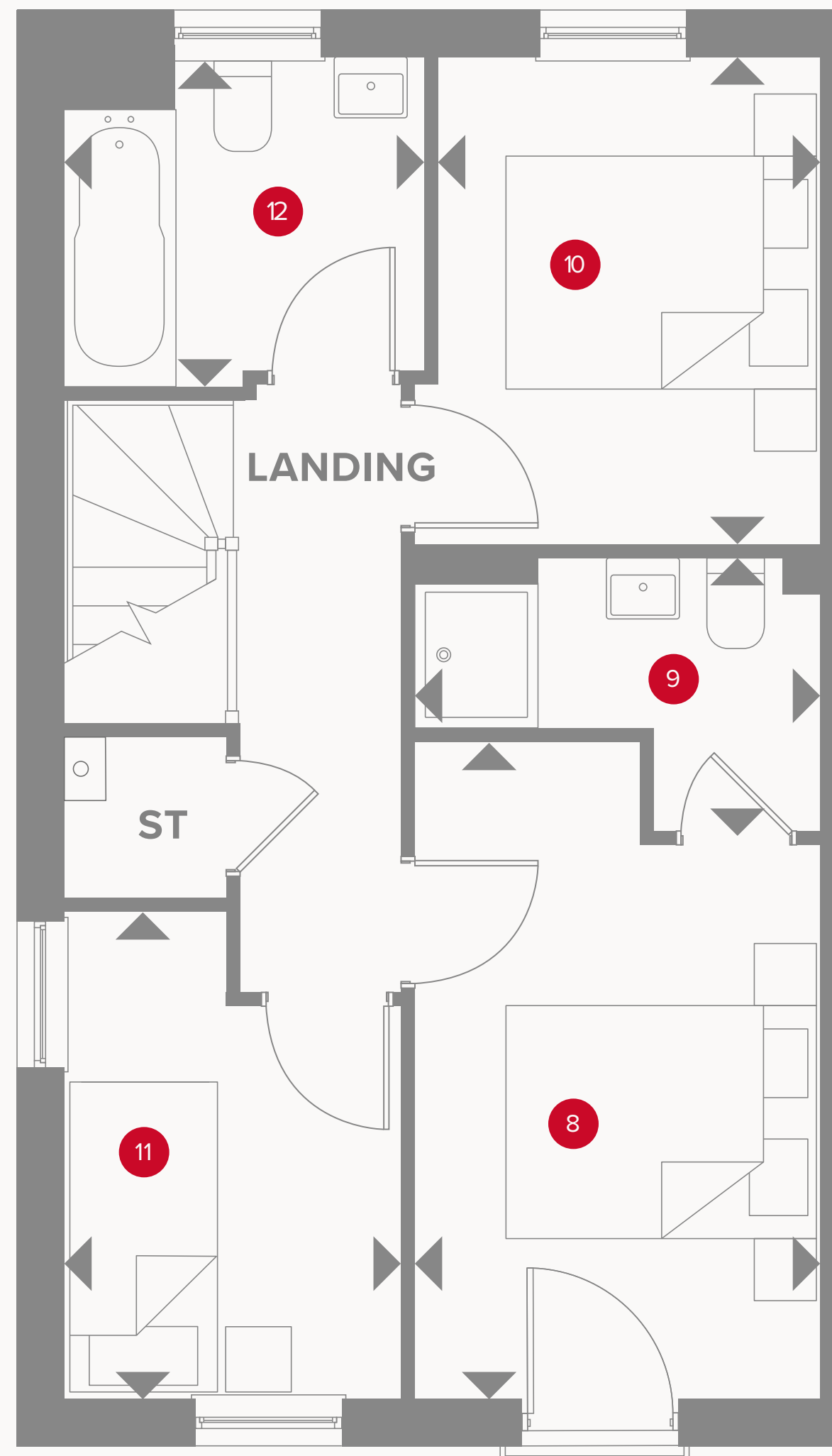

**CONSUMER
CODE FOR
HOME BUILDERS**
www.consumercode.co.uk

Customers should note this illustration is an example of the Portman End Terrace house type. All dimensions indicated are approximate and the furniture layout is for illustrative purposes only. Homes may be 'handed' (mirror image) versions of the illustrations, and may be detached, semi-detached or terraced. Materials used may differ from plot to plot including render and roof tile colours. Detailed plans and specifications are available for inspection for each plot at our Customer Experience Suites during working hours and customers must check their individual specifications prior to making a reservation. Computer generated images are for indicative purposes only.

KEY

- ◀ Dimensions start
- ST Storage cupboard