



TAILORED

- REDROW -

THE MILL

EDINBURGH HOUSE
ONE & TWO BEDROOM APARTMENTS

 **REDROW**



TAILORED
- REDROW -

THE MILL

EDINBURGH HOUSE
ONE & TWO BEDROOM APARTMENTS

 **REDROW**

EXPLORE THE MILL APARTMENTS AT SPRINGFIELD



KEY

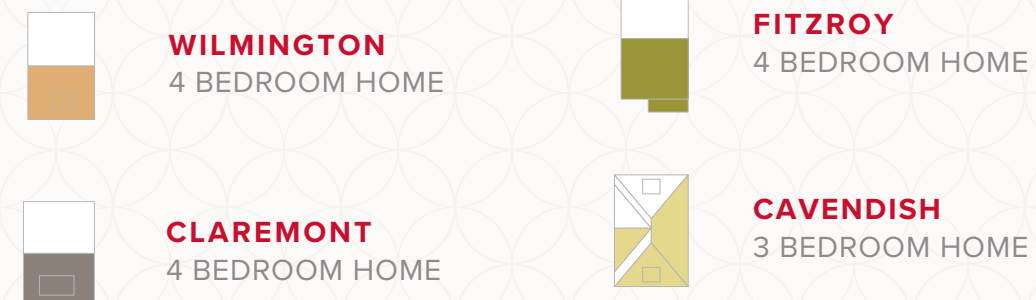

Parking restricted to size of vehicle on York house apartments.

- GG** – Gas Governor
- BCP** – Bin Collection Point
- V** – Visitor Parking
- UCP** – Under Croft Parking

This plan is indicative and is intended for guidance only and does not form part of any contract or agreement, nor does it show ownership boundaries, easements or wayleaves and is subject to change. For specific details, other than general site layout, please liaise directly with our Sales Consultant.



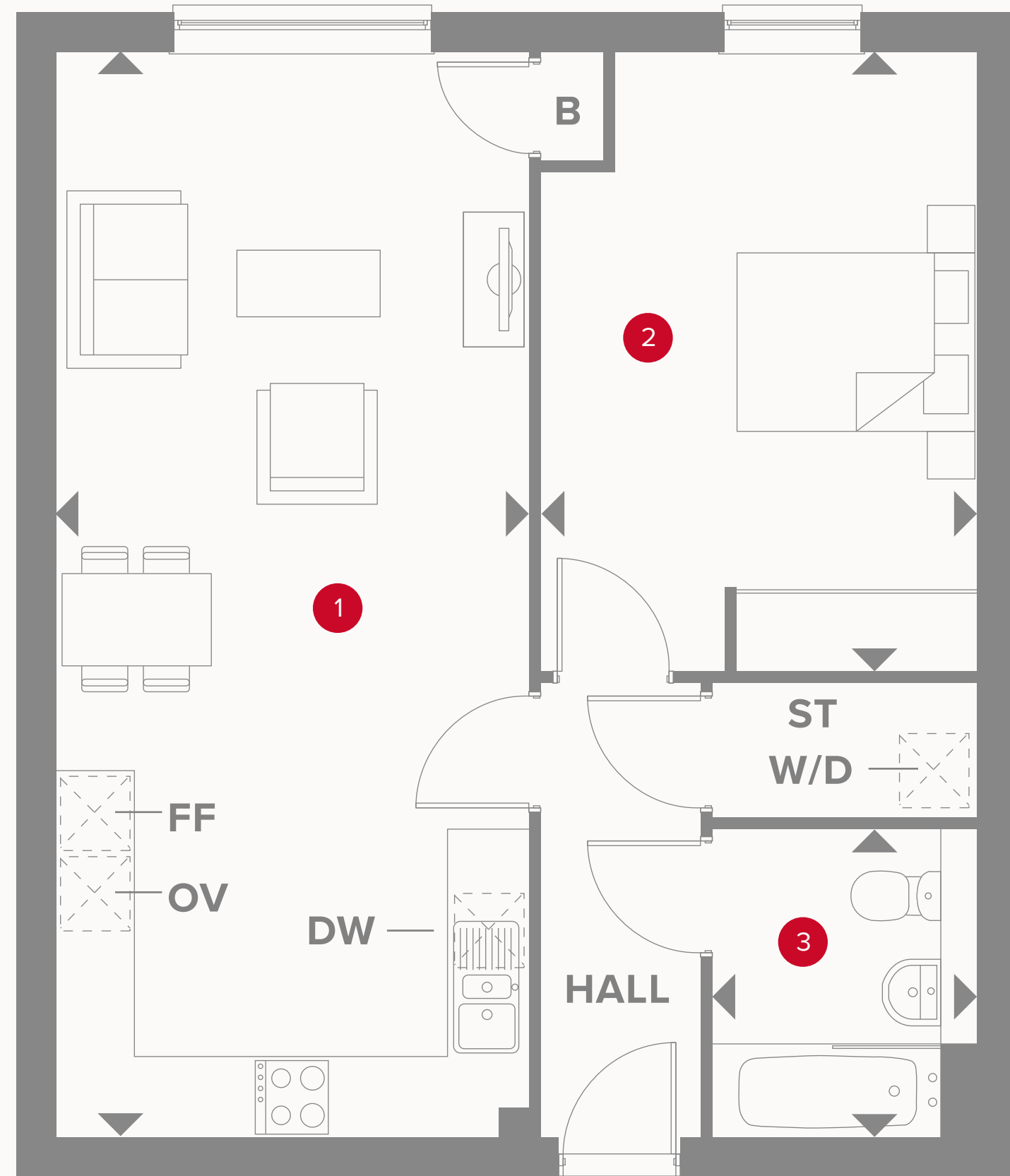

APARTMENT TYPE A

1	Kitchen/Lounge/Dining	11'6" x 26'6"	3.51 x 8.07 m
2	Bedroom	10'8" x 15'1"	3.25 x 4.59 m
3	Bathroom	6'6" x 7'7"	1.97 x 2.30 m

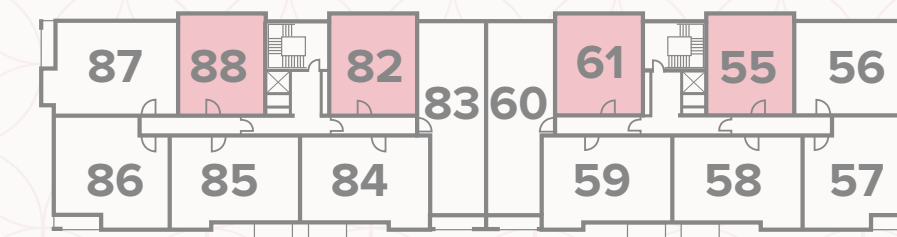

First Floor

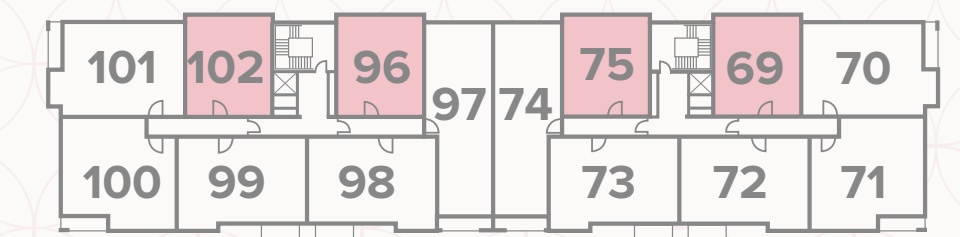

Third Floor

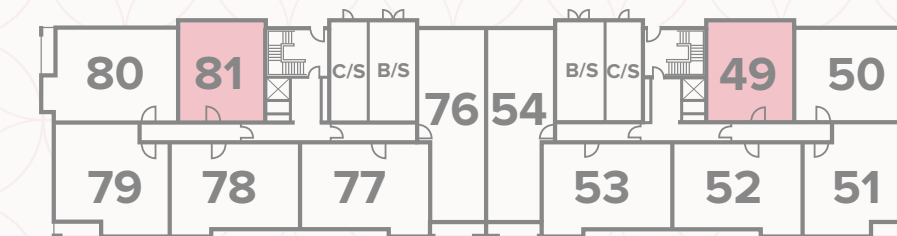

Ground Floor

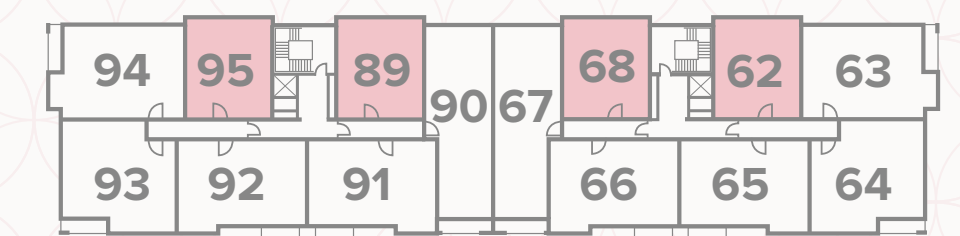

Second Floor

KEY

- Hob
- Oven
- Fridge/freezer
- Dimensions start

- Storage cupboard
- Washer/dryer
- Dishwasher
- Boiler

- Cycle Store
- Bin Store



Customers should note this illustration is an example of The Mill Apartments Edinburgh House apartment types. All dimensions indicated are approximate and the furniture layout is for illustrative purposes only. Homes may be 'handed' (mirror image) versions of the illustrations, and may be apartments. Materials used may differ from plot to plot including render and roof tile colours. Detailed plans and specifications are available for inspection for each plot at our Customer Experience Suite or Sales Centre during working hours and customers must check their individual specifications prior to making a reservation. Please note that the specification show in this plan may include optional upgrades from standard specification. Please speak with your Sales Consultant or visit MyRedrow for more information.

APARTMENT TYPE B

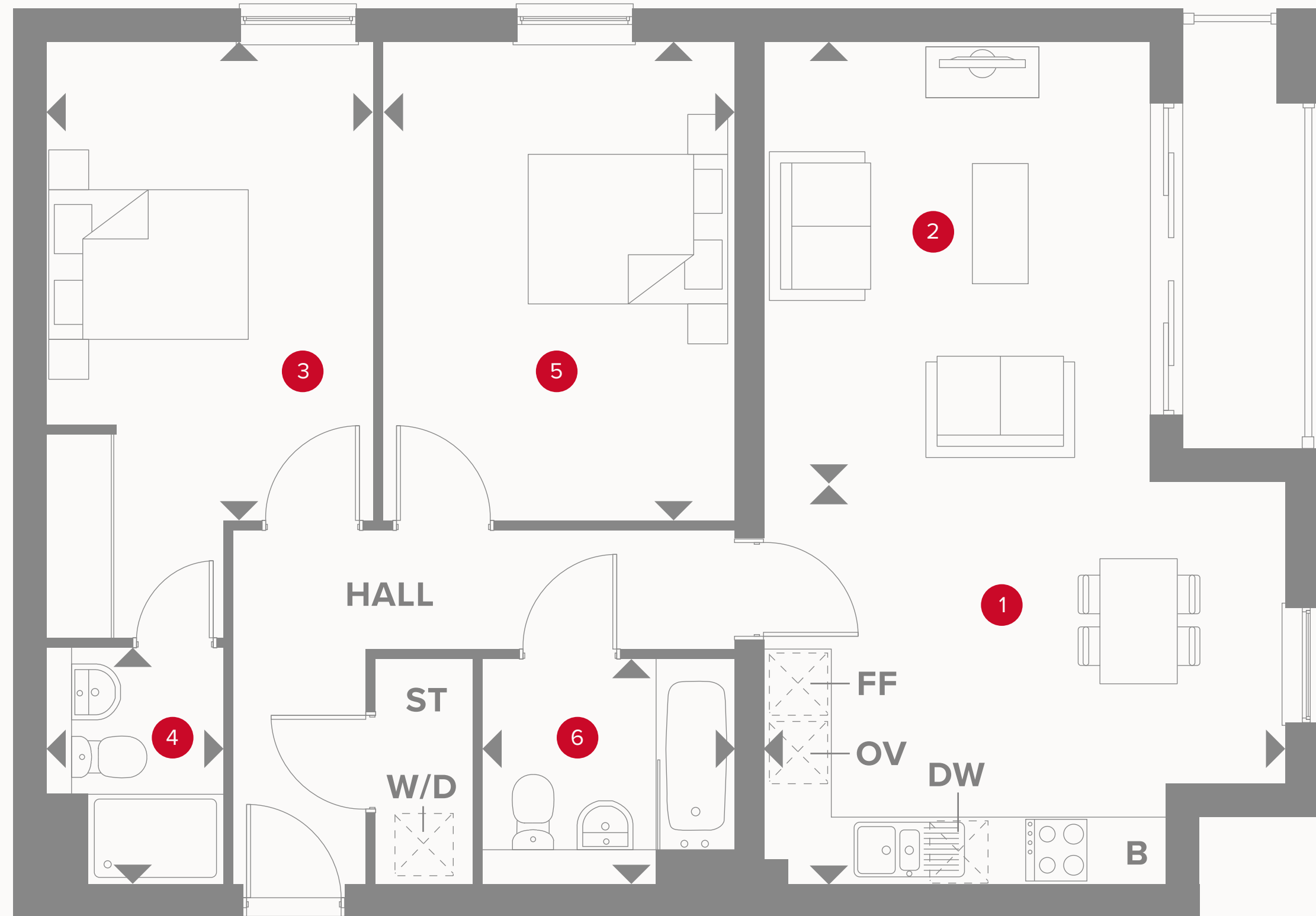

1	Kitchen/Dining	15'2" x 11'7"	4.62 x 3.56 m
2	Lounge	11'3" x 12'8"	3.42 x 3.90 m
3	Bedroom 1	9'6" x 17'4"	2.89 x 5.28 m
4	En-suite	5'2" x 6'11"	1.57 x 2.10 m
5	Bedroom 2	10'3" x 13'11"	3.11 x 4.24 m
6	Bathroom	7'4" x 6'7"	2.32 x 2.00 m

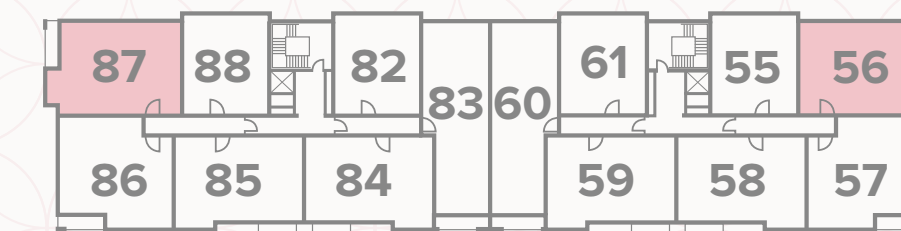

First Floor

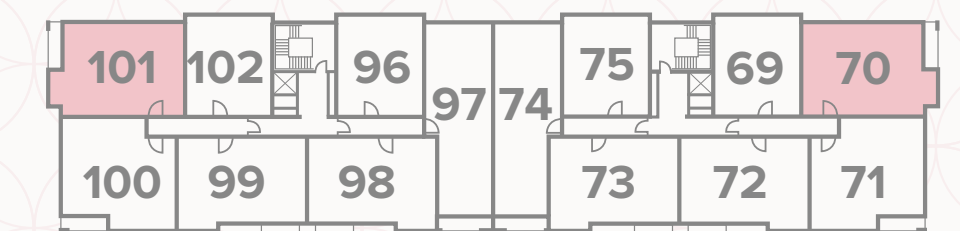

Third Floor

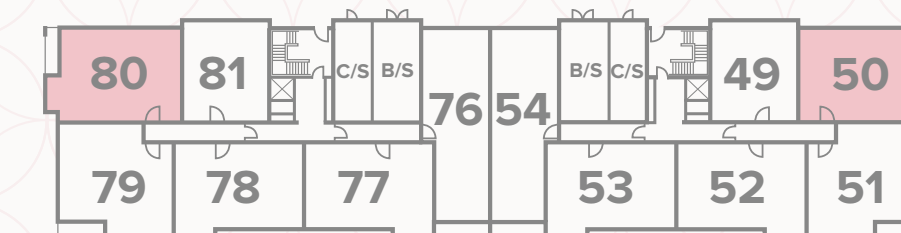

Ground Floor

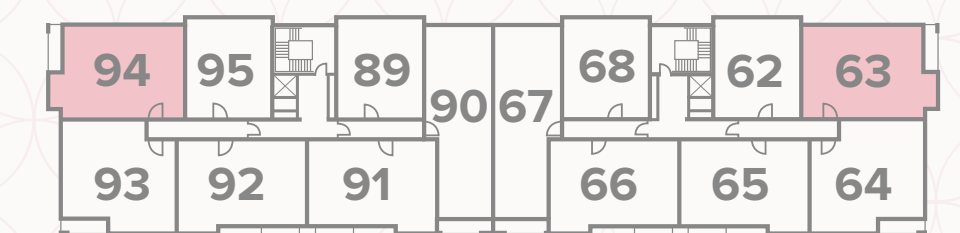

Second Floor

KEY

- Hob
- OV Oven
- FF Fridge/freezer
- Dimensions start

- ST Storage cupboard
- W/D Washer/dryer
- DW Dishwasher
- B Boiler

- C/S Cycle Store
- B/S Bin Store



Customers should note this illustration is an example of The Mill Apartments Edinburgh House apartment types. All dimensions indicated are approximate and the furniture layout is for illustrative purposes only. Homes may be 'handed' (mirror image) versions of the illustrations, and may be apartments. Materials used may differ from plot to plot including render and roof tile colours. Detailed plans and specifications are available for inspection for each plot at our Customer Experience Suite or Sales Centre during working hours and customers must check their individual specifications prior to making a reservation. Please note that the specification show in this plan may include optional upgrades from standard specification. Please speak with your Sales Consultant or visit MyRedrow for more information.

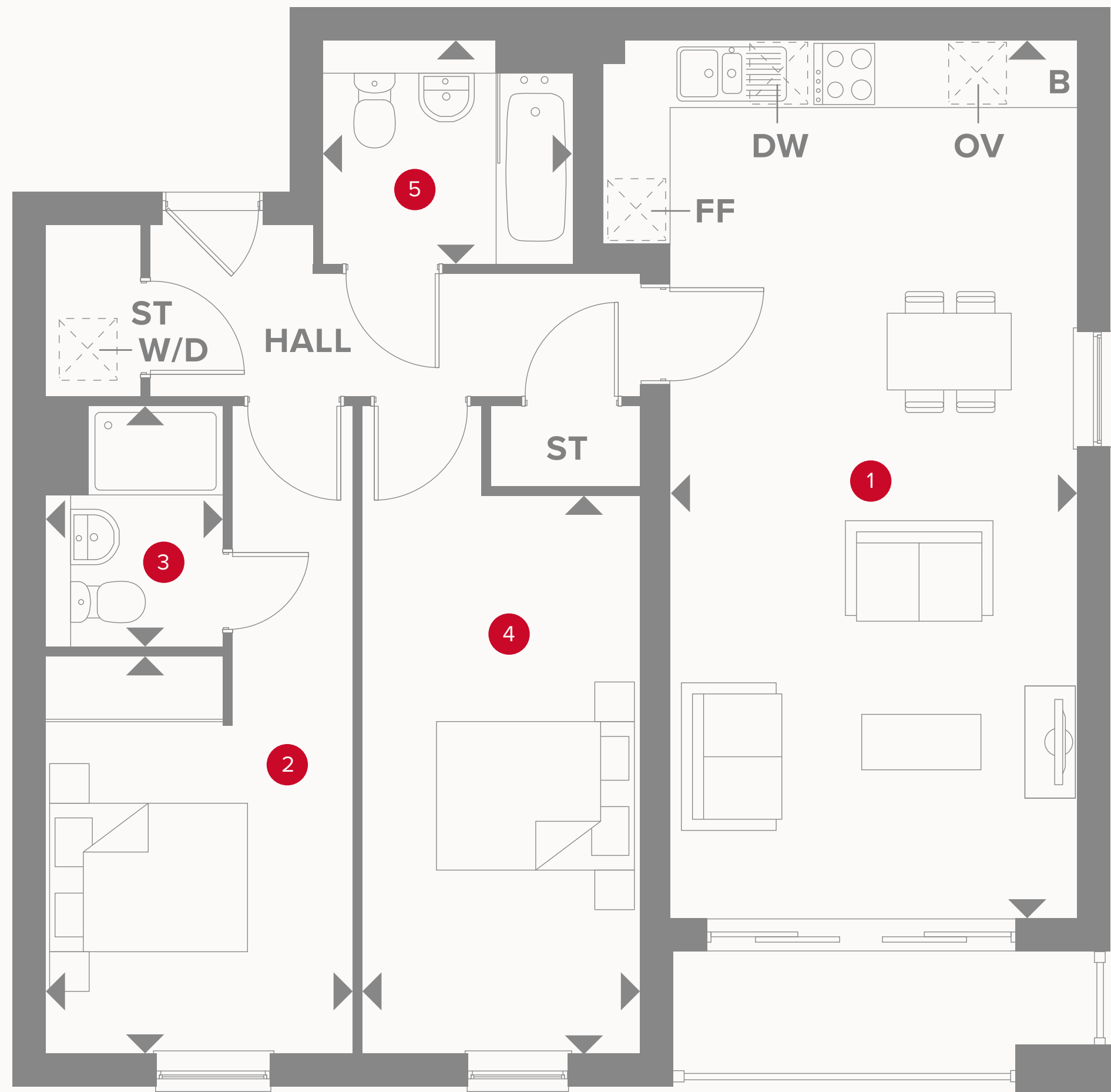

APARTMENT TYPE C

1	Kitchen/Lounge/Dining	11'11" x 25'9"	3.63 x 7.85 m
2	Bedroom 1	9'0" x 11'8"	2.73 x 3.54 m
3	En-suite	5'2" x 7'1"	1.58 x 2.15 m
4	Bedroom 2	8'2" x 16'4"	2.48 x 4.97 m
5	Bathroom	7'4" x 6'7"	2.24 x 2.00 m

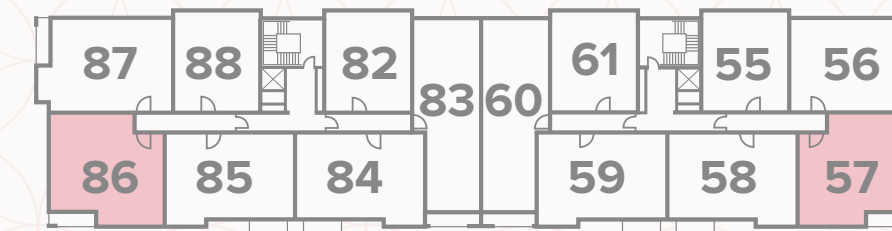

First Floor



Third Floor

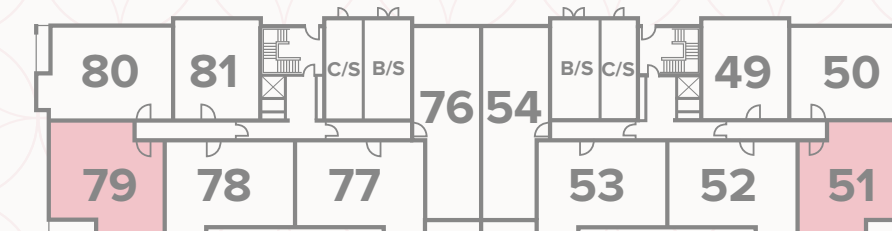

Ground Floor

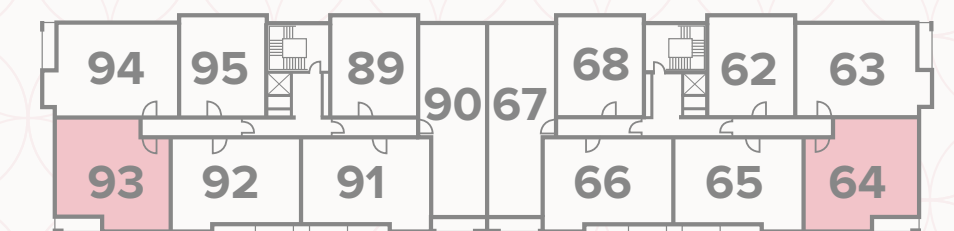

Second Floor

KEY

- Hob
- OV** Oven
- FF** Fridge/freezer
- Dimensions start

- ST** Storage cupboard
- W/D** Washer/dryer
- DW** Dishwasher
- B** Boiler

- C/S** Cycle Store
- B/S** Bin Store



Customers should note this illustration is an example of The Mill Apartments Edinburgh House apartment types. All dimensions indicated are approximate and the furniture layout is for illustrative purposes only. Homes may be 'handed' (mirror image) versions of the illustrations, and may be apartments. Materials used may differ from plot to plot including render and roof tile colours. Detailed plans and specifications are available for inspection for each plot at our Customer Experience Suite or Sales Centre during working hours and customers must check their individual specifications prior to making a reservation. Please note that the specification show in this plan may include optional upgrades from standard specification. Please speak with your Sales Consultant or visit MyRedrow for more information.

APARTMENT TYPE D

1	Kitchen/Lounge/Dining	12'11" x 22'4"	3.93 x 6.80 m
2	Bedroom 1	10'1" x 11'4"	3.05 x 3.44 m
3	En-suite	6'7" x 6'0"	2.00 x 1.82 m
4	Bedroom 2	10'1" x 11'11"	3.07 x 3.62 m
5	Bathroom	10'7" x 6'5"	3.21 x 1.96 m

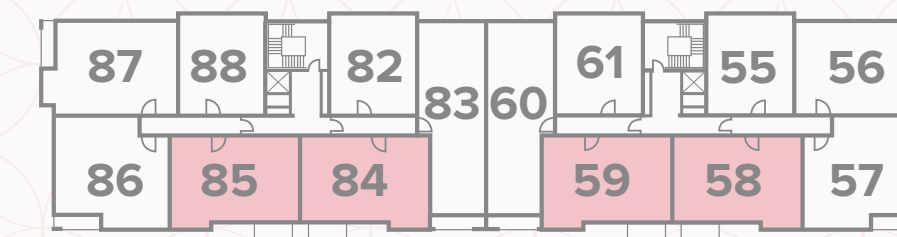

First Floor

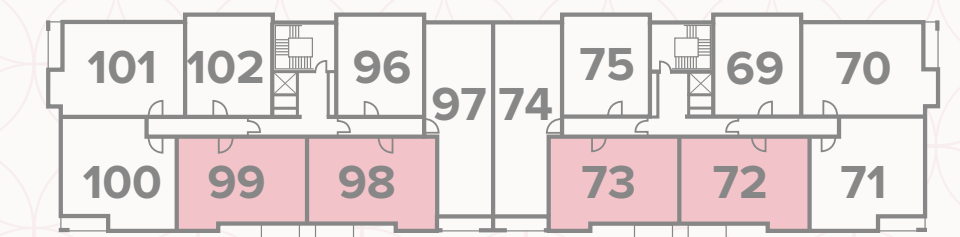

Third Floor

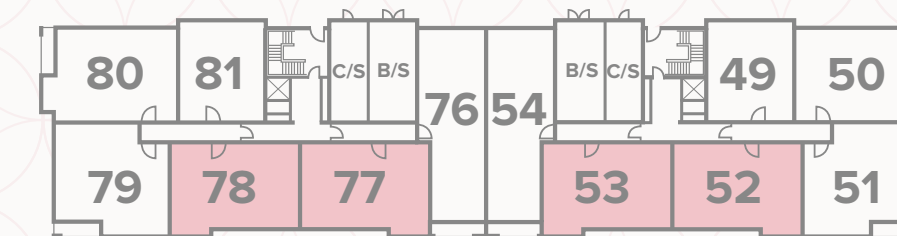



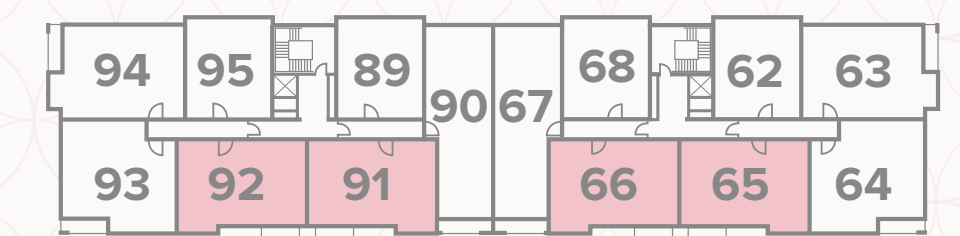

Ground Floor

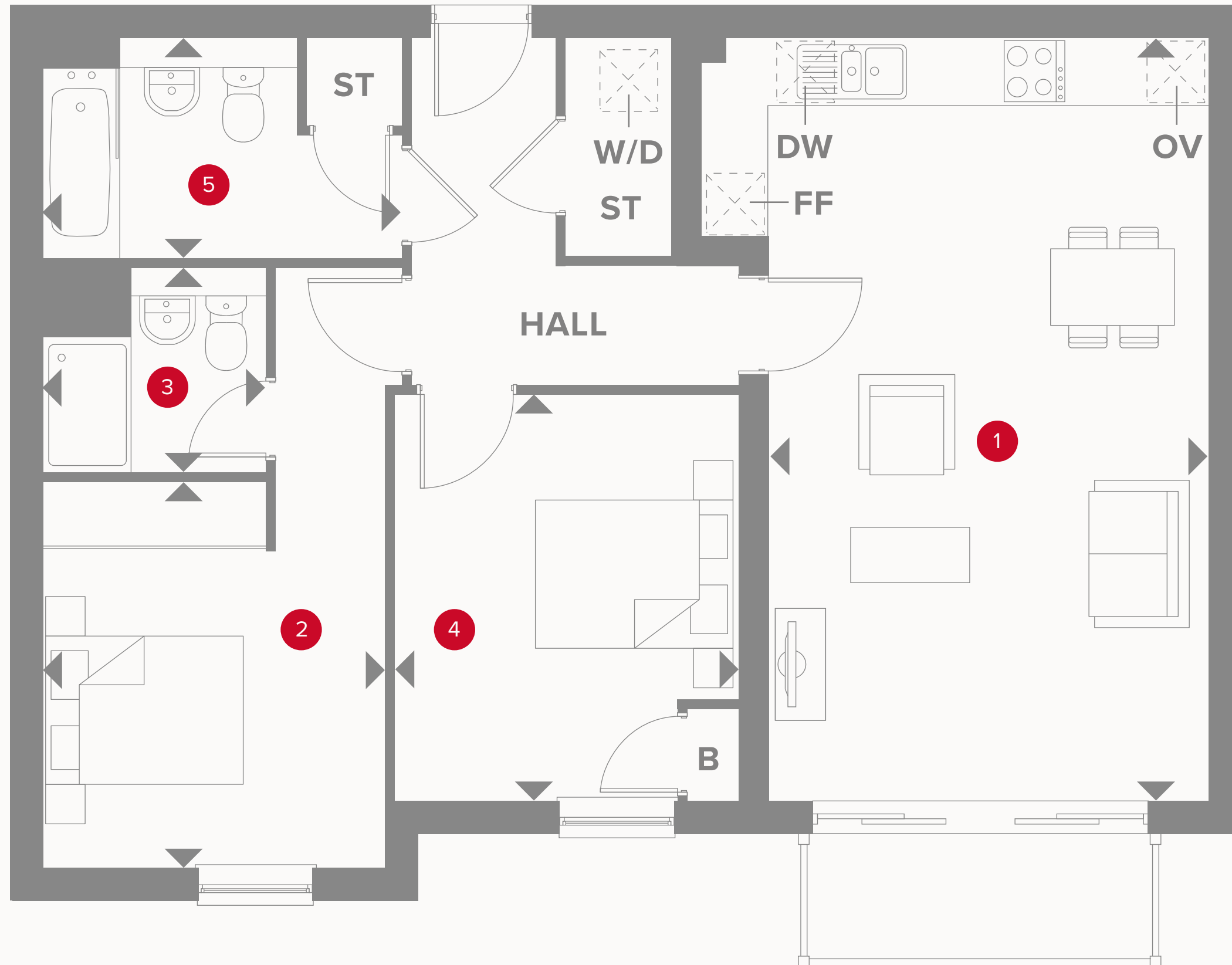





Second Floor



KEY

-  Hob
-  OV Oven
-  FF Fridge/freezer
-  Dimensions start

-  ST Storage cupboard
-  W/D Washer/dryer
-  DW Dishwasher
-  B Boiler

-  C/S Cycle Store
-  B/S Bin Store



Customers should note this illustration is an example of The Mill Apartments Edinburgh House apartment types. All dimensions indicated are approximate and the furniture layout is for illustrative purposes only. Homes may be 'handed' (mirror image) versions of the illustrations, and may be apartments. Materials used may differ from plot to plot including render and roof tile colours. Detailed plans and specifications are available for inspection for each plot at our Customer Experience Suite or Sales Centre during working hours and customers must check their individual specifications prior to making a reservation. Please note that the specification show in this plan may include optional upgrades from standard specification. Please speak with your Sales Consultant or visit MyRedrow for more information.

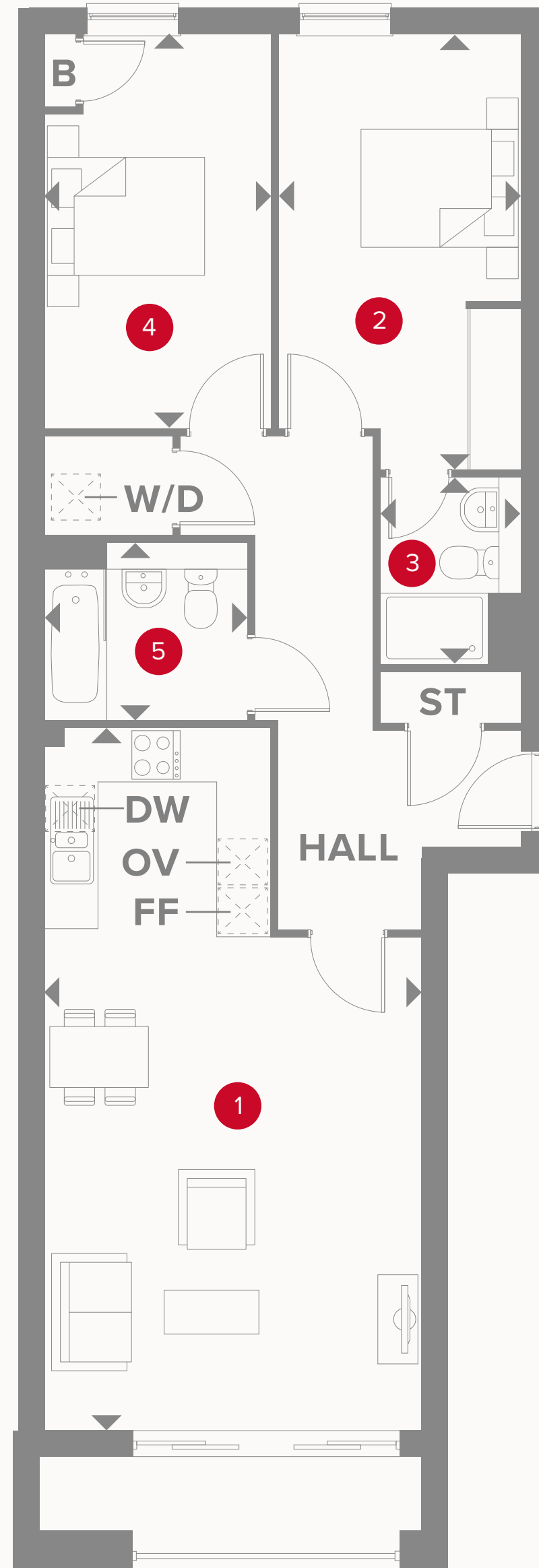

APARTMENT TYPE E

1	Kitchen/Lounge/Dining	14'0" x 25'11"	4.26 x 7.88 m
2	Bedroom 1	9'0" x 16'0"	2.74 x 4.87 m
3	En-suite	5'2" x 6'11"	1.57 x 2.10 m
4	Bedroom 2	8'4" x 14'6"	2.54 x 4.42 m
5	Bathroom	7'6" x 6'7"	2.27 x 2.00 m

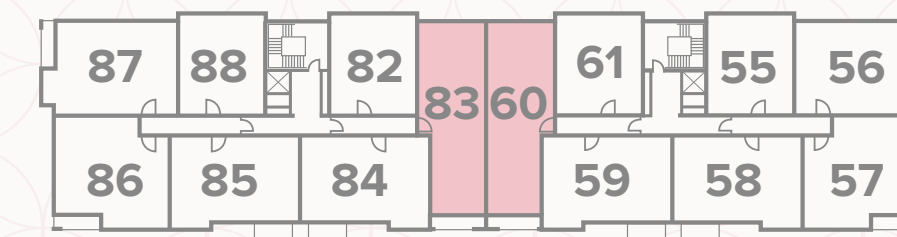

First Floor

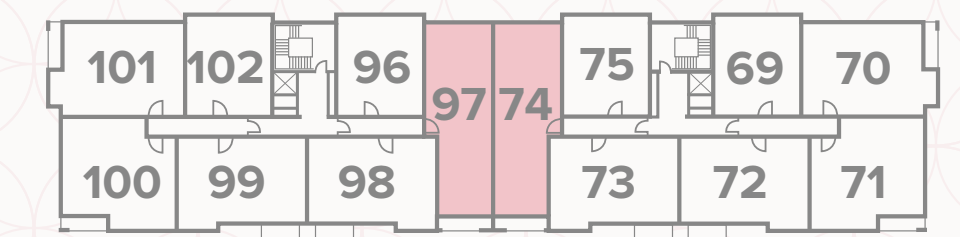

Third Floor

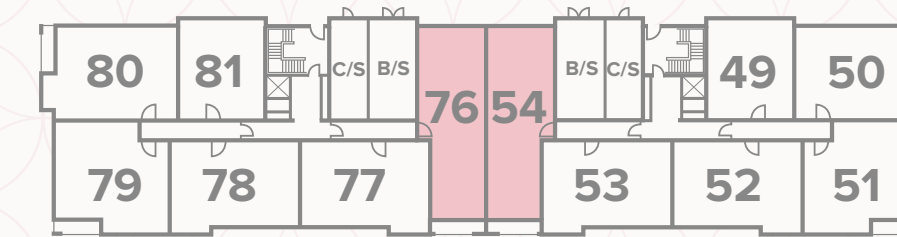

Ground Floor

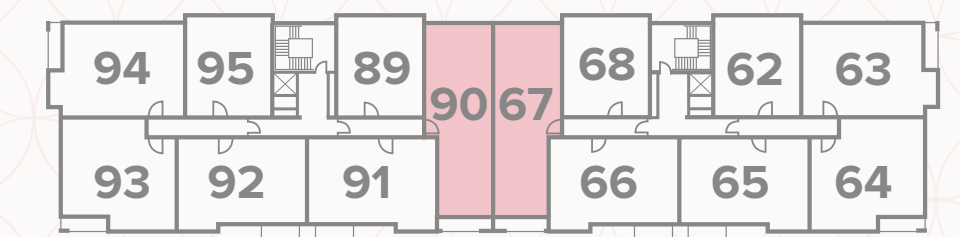

Second Floor

KEY

- Hob
- Oven
- Fridge/freezer
- Dimensions start

- Storage cupboard
- Washer/dryer
- Dishwasher
- Boiler

- Cycle Store
- Bin Store



Customers should note this illustration is an example of The Mill Apartments Edinburgh House apartment types. All dimensions indicated are approximate and the furniture layout is for illustrative purposes only. Homes may be 'handed' (mirror image) versions of the illustrations, and may be apartments. Materials used may differ from plot to plot including render and roof tile colours. Detailed plans and specifications are available for inspection for each plot at our Customer Experience Suite or Sales Centre during working hours and customers must check their individual specifications prior to making a reservation. Please note that the specification show in this plan may include optional upgrades from standard specification. Please speak with your Sales Consultant or visit MyRedrow for more information.

PLAN YOUR DREAM HOME



KITCHEN

Kitchen Styles

Exclusive linear handleless accent kitchen designs. Subject to build stage. See Sales Consultant for details.

Worktop and Upstand

Granite worktop and matching upstand with stainless steel splashback behind hob.

Sink

Stainless steel bowl and a half sink with mixer tap.

Kitchen & Dining Lighting

LED under cupboard downlights provided where shown on kitchen layout drawings. Refer to drawings for details.

Bosch Appliances

60cm ceramic hob with 4 Heat zones.
Single oven with microwave.
See kitchen layout or Sales Consultant for details.

60cm extractor hood.

Dishwasher.

Integrated fridge/freezer 50/50 split.

Free standing washer/dryer to laundry cupboard.

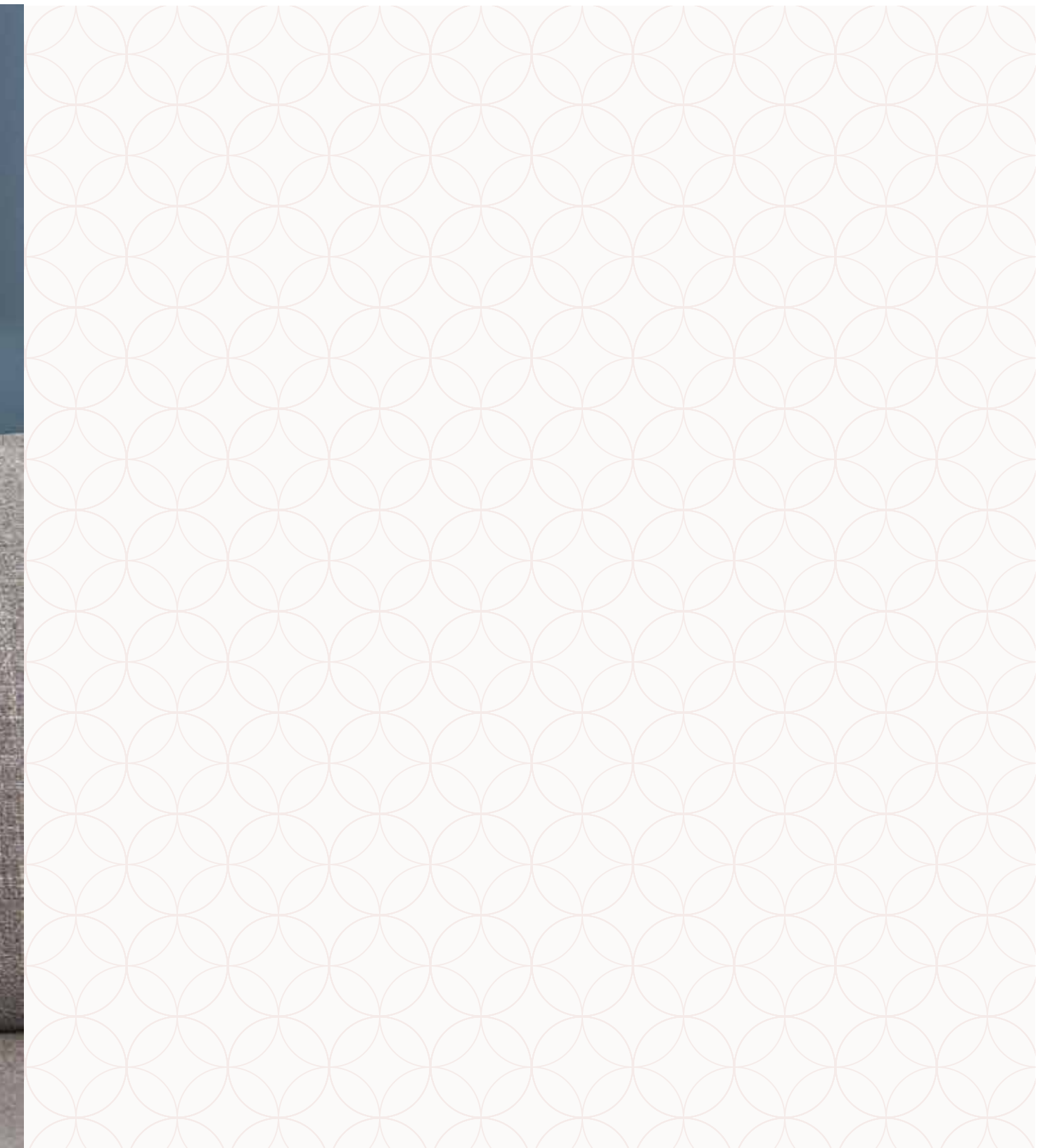

INTERIOR

Walls

Crown White Emulsion.

Ceilings

Crown White Emulsion.

External Doors

Contemporary oak entrance door.

Internal Doors

5 panel internal moulded door in satin white.

Internal Door Furniture

Polished Satin combination chrome effect lever handle on square rose plate.

TV Point

TV points located in lounge and bedroom 1 where applicable. See drawings or Sales Consultant for details.

Phone Point

Phone point to living area. Refer to drawing for details.

Central Heating

Full gas central heating with combi boiler to all apartments. See drawing for details.

Radiators

Myson radiators.

Wardrobes

Wardrobes to bedroom 1 only. See Sales Consultant for details.

Lighting

Polished chrome downlights to kitchen, bathroom and en-suite. Refer to drawings for details.

Electrical Sockets / Switch plates

Low profile white electrical sockets and plates.

OUR LUXURY
SPECIFICATIONS
ARE CAREFULLY
CONSIDERED
**AND BEAUTIFULLY
DESIGNED TO MAKE
THE MOST OF YOUR
NEW HOME**



BATHROOM & EN-SUITE

Sanitaryware

Ideal Standard wall hung sanitaryware.

Wall Tiles

A choice of Porcelanosa wall tiles to bathroom and en suite where applicable.

Full height tiling to shower where applicable.

Full height tiling around bath with shower and screen.

Half height tiling to all other walls.

See Sales Consultant for details.

Vanity Unit

Full Wall Oak coloured built-in wooden vanity unit including mirror and shelves where applicable, bath panel to match. See Sales Consultant for details.

Towel Warmer

Dual fuel towel rail.

Shaver Socket

Shaver socket in bathroom and en-suite where applicable. See Sales Consultant for details.



COMMUNAL AREA

Main Entrance

GRP/Steel to main entrance and rear door.

Entry System

Video entry system.

Mail System

External bank of post boxes.

Flooring

Flooring to communal areas.

Storage

Bin and cycle stores.

Landscaping

Landscaping to communal areas.

Light to Front

PIR lighting control sensors.

External balcony light.

Parking

1x allocated car parking space per apartment.

Undercroft parking to selected apartments.

See Sales Consultant for details.

Balconies

Balconies with railings to selected plots.

Lifts

Lift to all floors. One per apartment block.