



HERITAGE

- REDROW -

THE HEXHAM

TWO BEDROOM TERRACE HOME

 **REDROW**

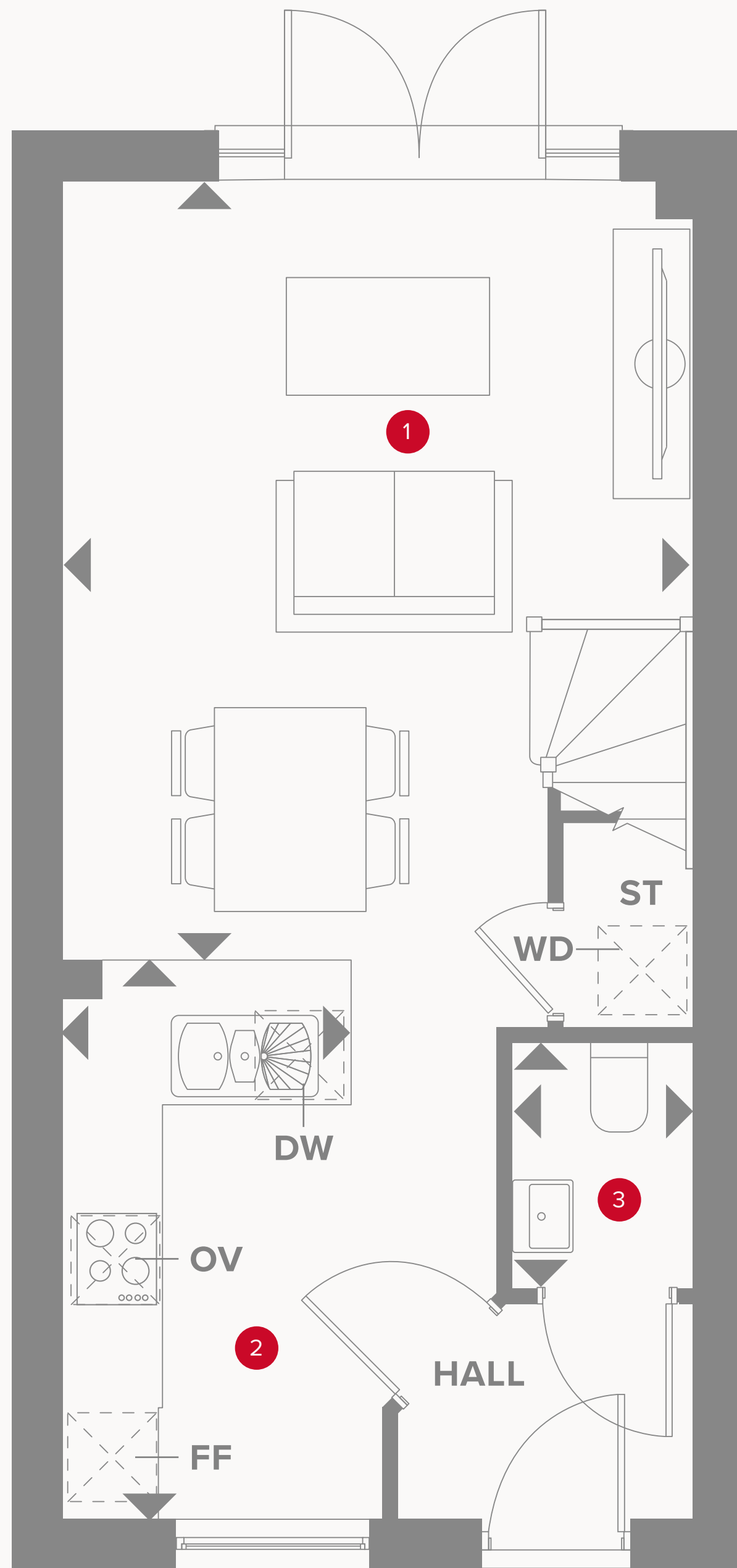

THE HEXHAM GROUND FLOOR

1	Lounge/Dining	15'9" x 12'8"	4.80 x 3.87m
2	Kitchen	13'3" x 5'10"	3.44 x 1.77m
3	Cloaks	5'0" x 3'8"	1.52 x 1.11m



KEY

- Hob
- OV** Oven
- FF** Fridge/freezer
- DW** Dishwasher space

- Dimensions start
- ST** Storage cupboard
- WD** Washing/Dryer

*Please note there are variations to plots speak to our Sales Consultant for more information.

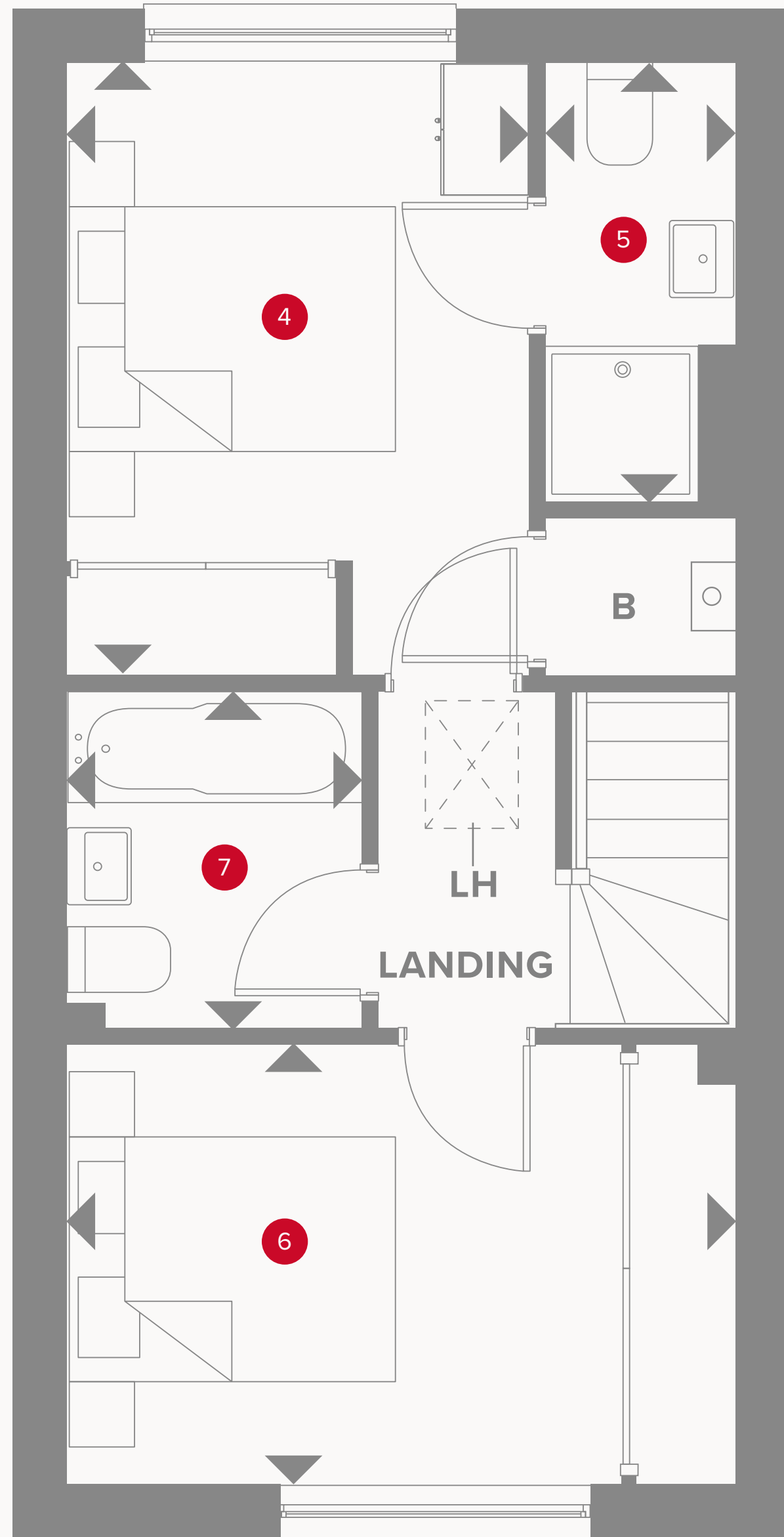

THE HEXHAM FIRST FLOOR

4	Bedroom 1	11'8" x 8'10"	3.55 x 2.68m
5	En-suite	8'4" x 3'7"	2.54 x 1.10m
6	Bedroom 2	12'8" x 8'4"	3.87 x 2.55m
7	Bathroom	6'6" x 5'7"	1.97 x 1.71m



Customers should note this illustration is an example of the Hexham house type. All dimensions indicated are approximate and the furniture layout is for illustrative purposes only. Homes may be 'handed' (mirror image) versions of the illustrations, and may be detached, semi-detached or terraced. Materials used may differ from plot to plot including render and roof tile colours. Detailed plans and specifications are available for inspection for each plot at our Customer Experience Suite or Sales Centre during working hours and customers must check their individual specifications prior to making a reservation. Please note that the specification show in this plan may include optional upgrades from standard specification. Please speak with your Sales Consultant or visit MyRedrow for more information.

KEY

- ◀ Dimensions start
- B** Boiler
- LH** Loft hatch

*Please note there are variations to plots speak to our Sales Consultant for more information.