



**HERITAGE**

- REDROW -

# **THE BALMORAL**

FOUR BEDROOM HOME





# THE BALMORAL GROUND FLOOR

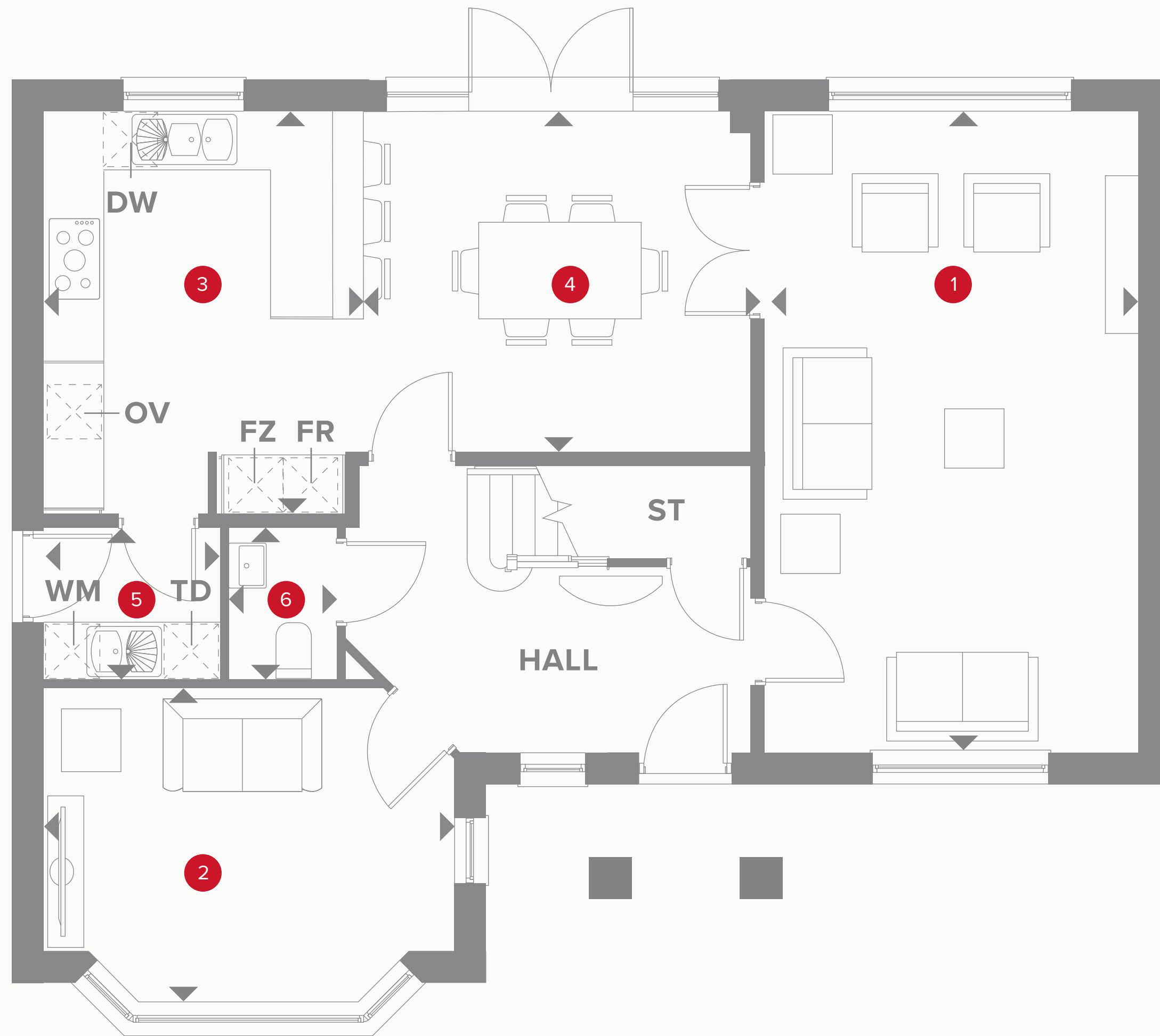

1	Lounge	21'6" x 12'6"	6.56 x 3.81 m
2	Family room	13'9" x 10'4"	4.19 x 3.16 m
3	Kitchen	13'6" x 10'5"	4.11 x 3.18 m
4	Dining	13'3" x 11'5"	4.03 x 3.48 m
5	Utility	5'11" x 5'1"	1.80 x 1.54 m
6	Cloaks	5'4" x 5'1"	1.63 x 1.54 m



## KEY

- |                   |                                 |                            |
|-------------------|---------------------------------|----------------------------|
| Hob               | Dimensions start                | <b>ST</b> Storage cupboard |
| <b>OV</b> Oven    | <b>TD</b> Tumble dryer space    | <b>WC</b> Wine cooler      |
| <b>FR</b> Fridge  | <b>WM</b> Washing machine space | <b>MW</b> Microwave        |
| <b>FZ</b> Freezer | <b>DW</b> Dishwasher space      | <b>SO</b> Steam Oven       |

# THE BALMORAL FIRST FLOOR

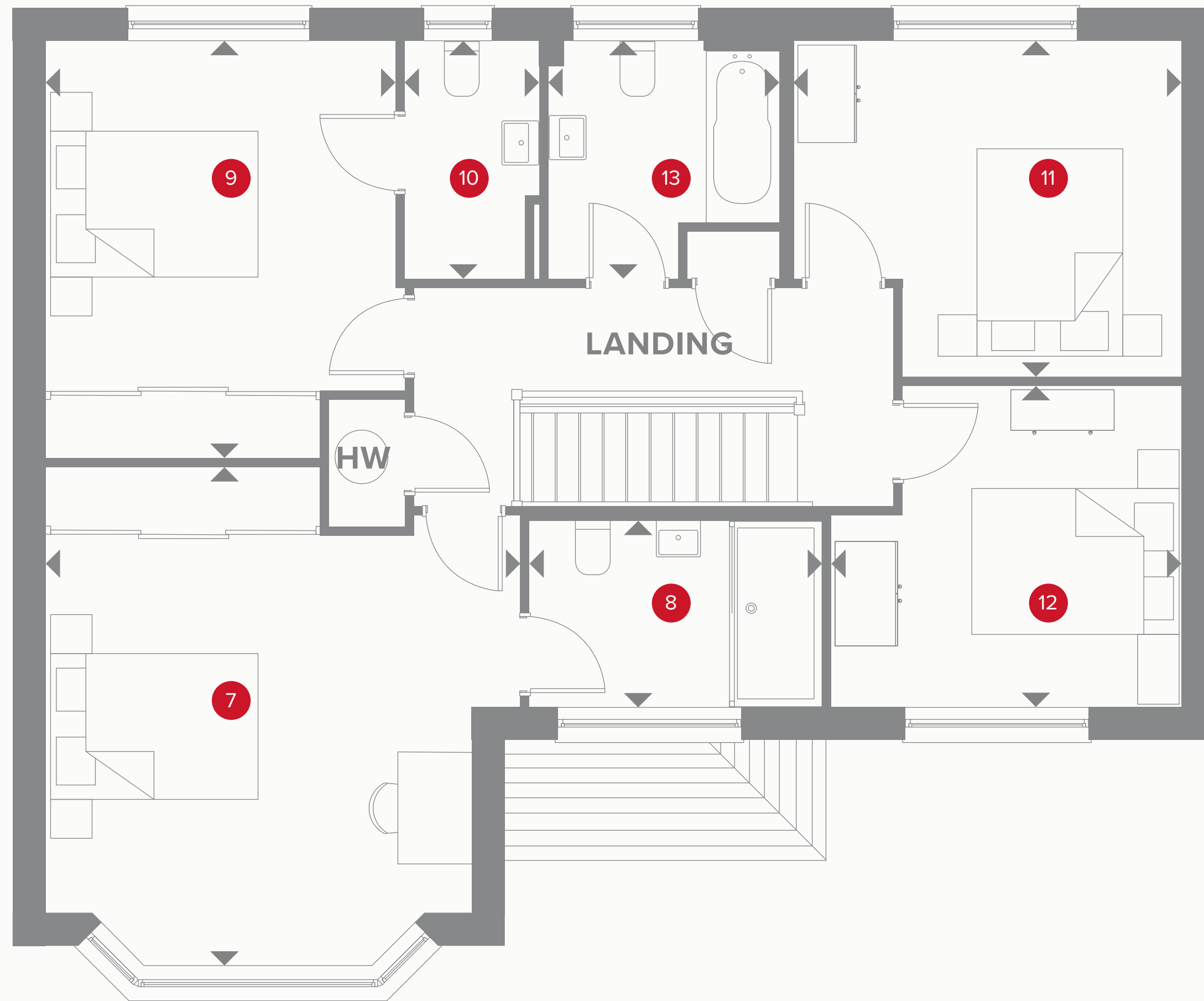

7	Bedroom 1	15'11" x 15'4"	4.86 x 4.67 m
8	En-suite 1	9'5" x 5'11"	2.88 x 1.81 m
9	Bedroom 2	13'5" x 11'4"	4.10 x 3.45 m
10	En-suite 2	7'8" x 4'4"	2.33 x 1.31 m
11	Bedroom 3	12'6" x 10'4"	3.81 x 3.15 m
12	Bedroom 4	11'3" x 10'11"	3.44 x 3.32 m
13	Bathroom	7'8" x 7'5"	2.33 x 2.27 m



## KEY

- ◀ Dimensions start
- HW Hot water storage

**CONSUMER  
CODE FOR  
HOME BUILDERS**  
[www.consumercode.co.uk](http://www.consumercode.co.uk)

Customers should note this illustration is an example of the Balmoral house type. All dimensions indicated are approximate and the furniture layout is for illustrative purposes only. Homes may be 'handed' (mirror image) versions of the illustrations, and may be detached, semi-detached or terraced. Materials used may differ from plot to plot including render and roof tile colours. Detailed plans and specifications are available for inspection for each plot at our Sales Centre during working hours and customers must check their individual specifications prior to making a reservation.