



HERITAGE

- REDROW -

THE SHAFTESBURY

FOUR BEDROOM DETACHED HOME

 **REDROW**

THE SHAFTESBURY GROUND FLOOR

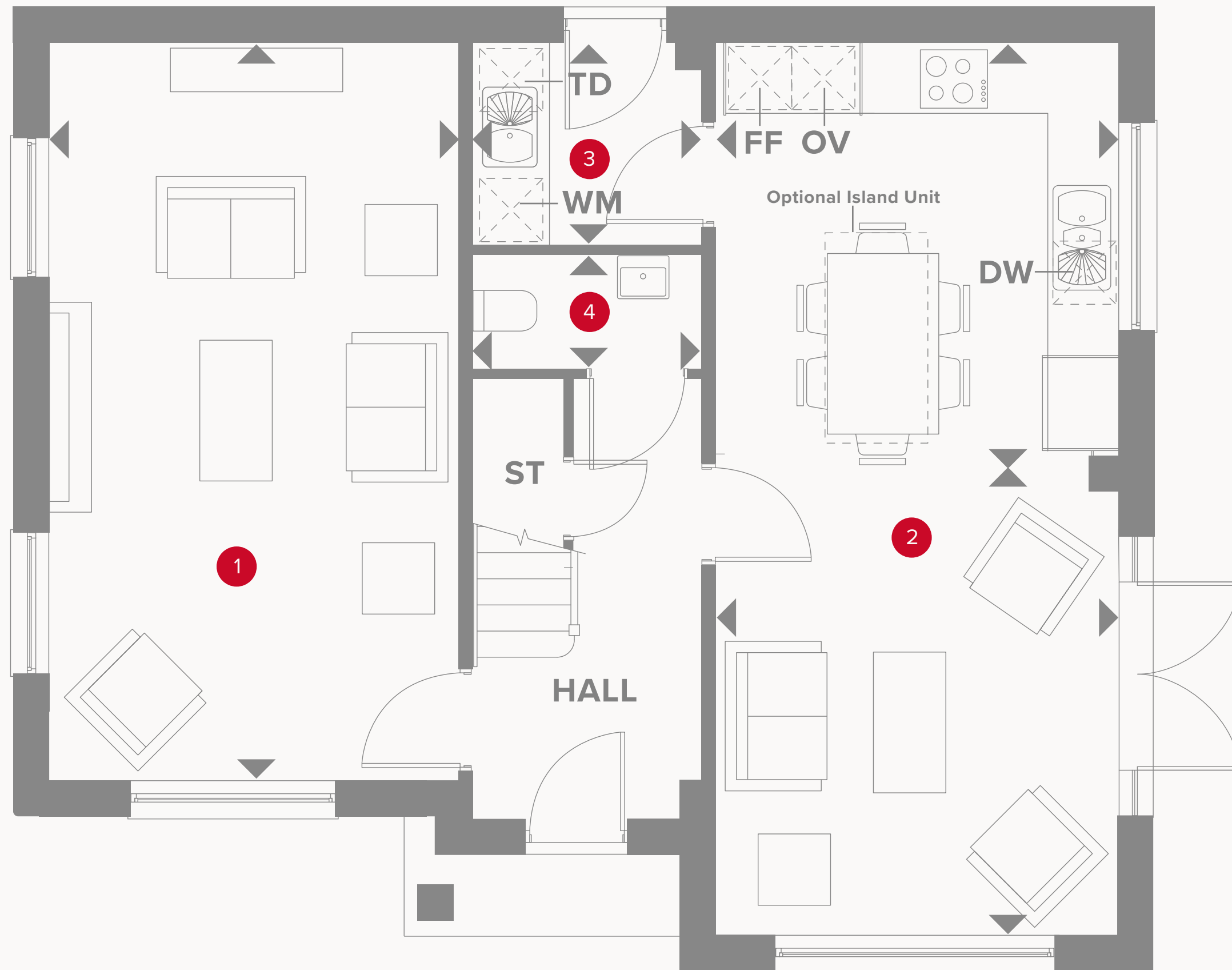

1	Lounge	21'2" x 11'8"	6.44 x 3.56 m
2	Kitchen/Dining	25'7" x 11'7"	7.79 x 3.52 m
3	Utility	6'6" x 5'9"	1.99 x 1.75 m
4	Cloaks	6'6" x 3'4"	1.99 x 1.01 m



KEY

	Hob
OV	Oven
FF	Fridge/freezer
TD	Tumble dryer space

	Dimensions start
ST	Storage cupboard
WM	Washing machine space
DW	Dish washer space

THE SHAFTESBURY FIRST FLOOR

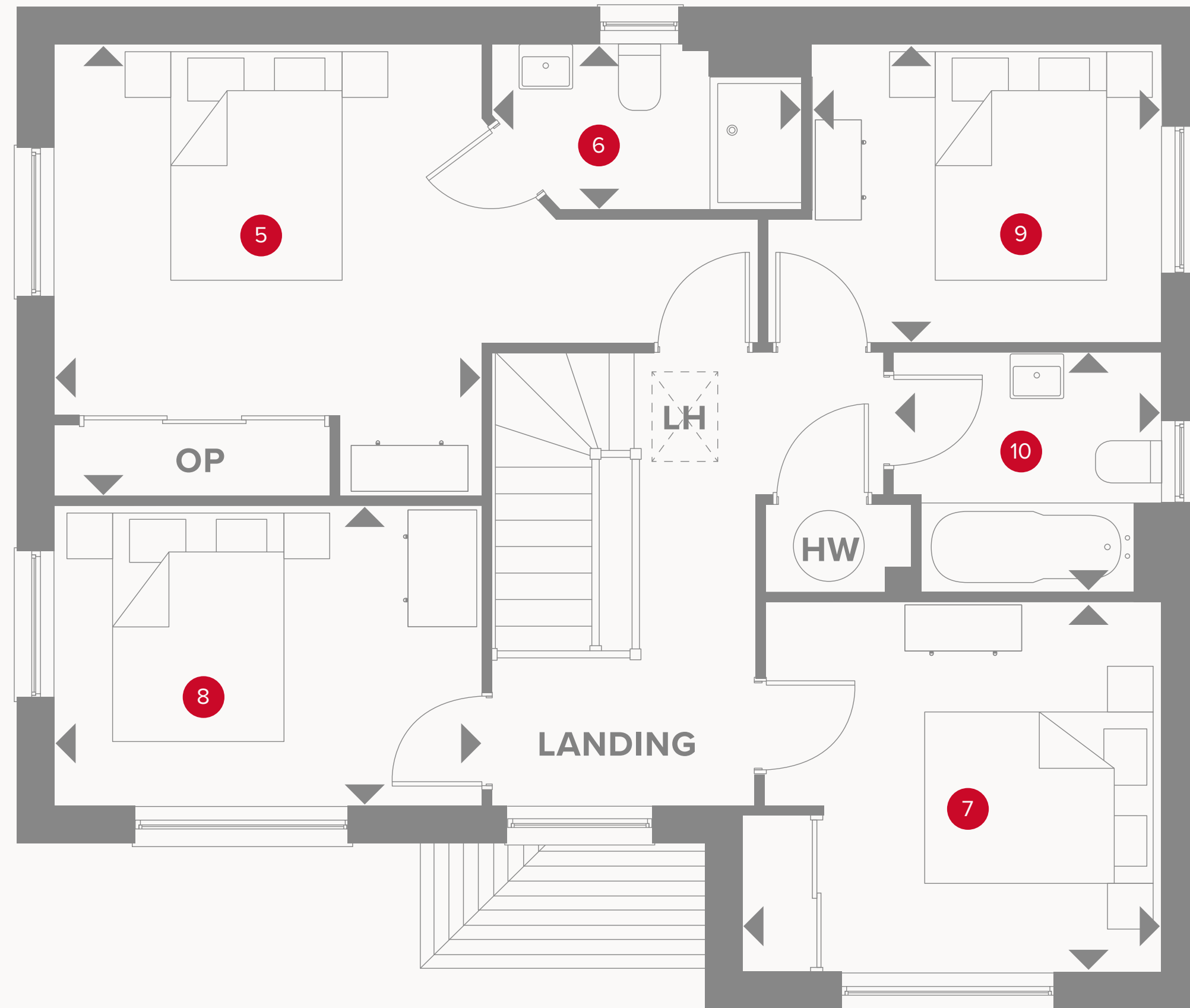

5	Bedroom 1	12'5" x 11'8"	3.80 x 3.62 m
6	En-suite	8'5" x 4'5"	2.58 x 1.38 m
7	Bedroom 2	11'7" x 10'3"	3.52 X 3.12m
8	Bedroom 3	11'11" x 8'4"	3.62 X 2.55m
9	Bedroom 4	10'10" x 8'2"	3.30 X 2.48m
10	Bathroom	7'3" x 6'6"	2.22 x 2.01 m



**CONSUMER
CODE FOR
HOME BUILDERS**
www.consumercode.co.uk

Customers should note this illustration is an example of the Shaftesbury house type. All dimensions indicated are approximate and the furniture layout is for illustrative purposes only. Homes may be 'handed' (mirror image) versions of the illustrations, and may be detached, semi-detached or terraced. Materials used may differ from plot to plot including render and roof tile colours. Detailed plans and specifications are available for inspection for each plot at our Customer Experience Suites during working hours and customers must check their individual specifications prior to making a reservation. Computer generated images are for indicative purposes only.

KEY

◀ Dimensions start **LH** Loft hatch
OP Optional wardrobe **HW** Hot water cylinder