



HERITAGE

- REDROW -

THE OXFORD LIFESTYLE

THREE BEDROOM HOME





HERITAGE

- REDROW -

THE OXFORD LIFESTYLE

THREE BEDROOM HOME



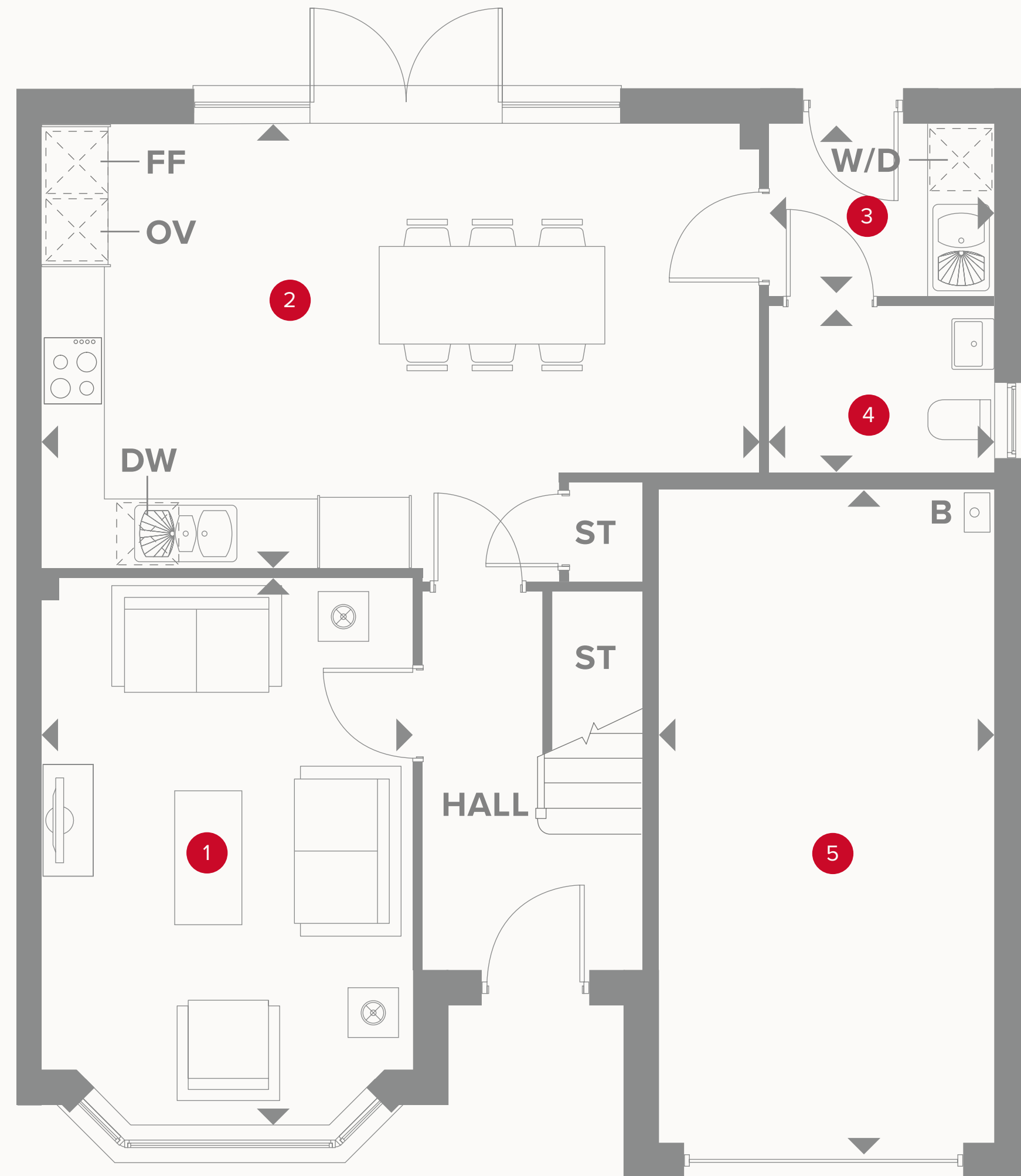

THE OXFORD LIFESTYLE GROUND FLOOR

1	Lounge	15'8" x 10'10"	4.77 x 3.29 m
2	Kitchen/ Dining	21'0" x 12'8"	6.41 x 3.87 m
3	Utility	6'6" x 4'11"	1.97 x 1.50 m
4	Cloaks	6'6" x 4'9"	1.97 x 1.45 m
5	Garage	19'7" x 9'10"	5.97 x 2.99 m



KEY

- Hob
- Oven
- Fridge/freezer

- Dimensions start
- Storage cupboard
- Washer / Dryer space
- Dish washer space
- Boiler

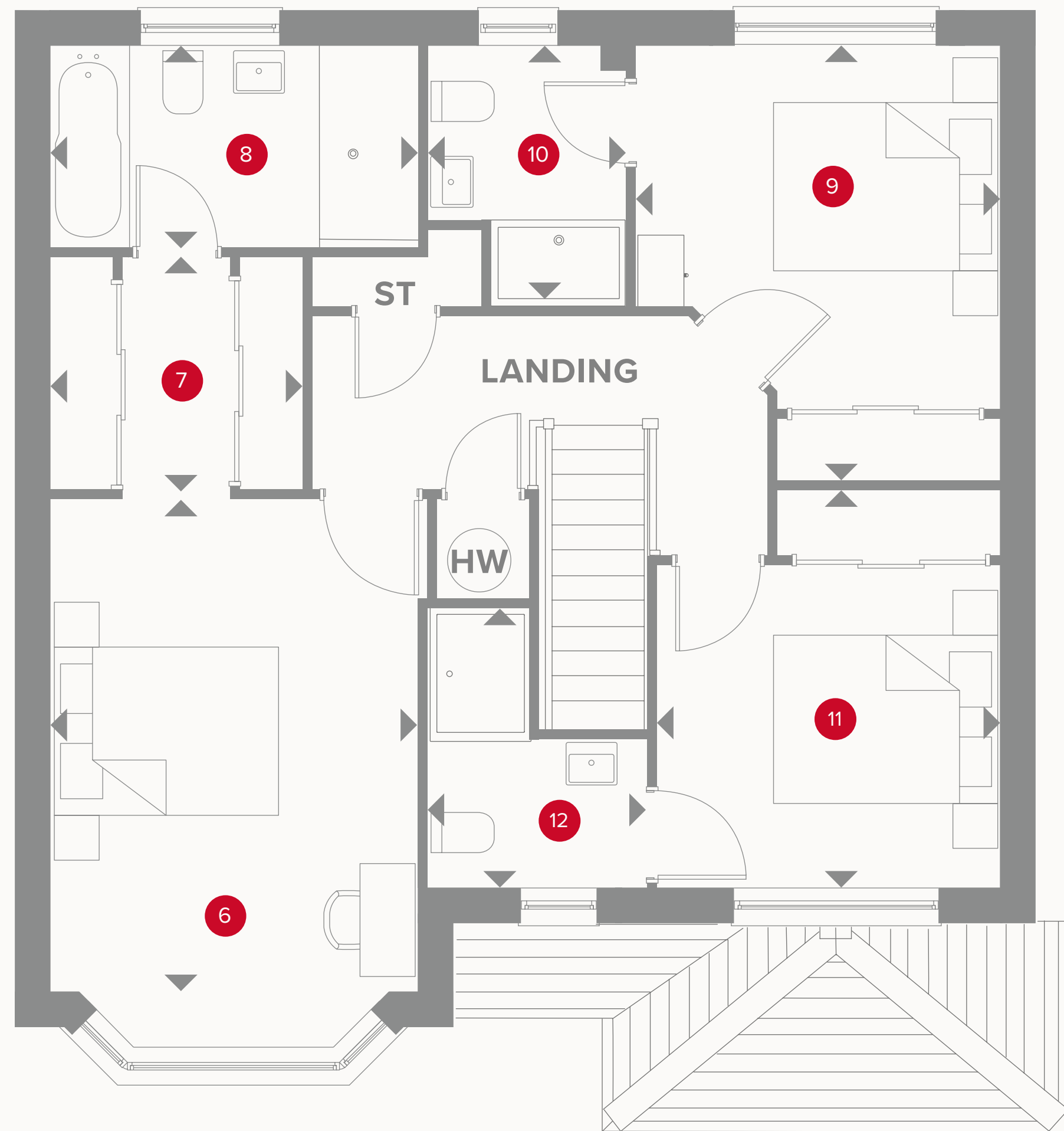

THE OXFORD LIFESTYLE FIRST FLOOR

6	Bedroom 1	14'3" x 10'10"	4.35 x 3.29 m
7	Dressing	7'6" x 6'8"	2.28 x 2.03 m
8	En-suite 1	10'10" x 5'11"	3.29 x 1.80 m
9	Bedroom 2	10'9" x 12'7"	3.27 x 3.84 m
10	En-suite 2	7'6" x 5'9"	2.29 x 1.75m
11	Bedroom 3	11'6" x 10'0"	3.51 x 3.05 m
12	En-suite 3	8'1" x 6'5"	2.46 x 1.95 m



KEY

- ◀ Dimensions start
- HW Hot water storage
- ST Storage cupboard



Customers should note this illustration is an example of the Oxford Lifestyle house type. All dimensions indicated are approximate and the furniture layout is for illustrative purposes only. Homes may be 'handed' (mirror image) versions of the illustrations. Materials used may differ from plot to plot including render and roof tile colours. Detailed plans and specifications are available for inspection for each plot at our Sales Centre during working hours and customers must check their individual specifications prior to making a reservation. All wardrobes are subject to site specification. Please see Sales Consultant for further details.