



HERITAGE

- REDROW -

THE SUNNINGDALE

FOUR BEDROOM DETACHED HOME



THE SUNNINGDALE GROUND FLOOR

1	Kitchen/Dining	19'11" x 14'0"	6.03 x 4.23m
2	Lounge	17'1" x 12'0"	5.15 x 3.63m
3	Snug	9'9" x 9'6"	2.96 x 2.88m
4	Utility	9'6" x 5'4"	2.88 x 1.61m
5	Cloaks	6'2" x 3'8"	1.86 x 1.10m
6	Garage	18'8" x 16'8"	5.64 x 5.03m



KEY

-  Hob
- OV** Oven
- FF** Fridge/freezer
- TD** Tumble dryer space

-  Dimensions start
- ST** Storage cupboard
- WM** Washing machine space
- DW** Dish washer space



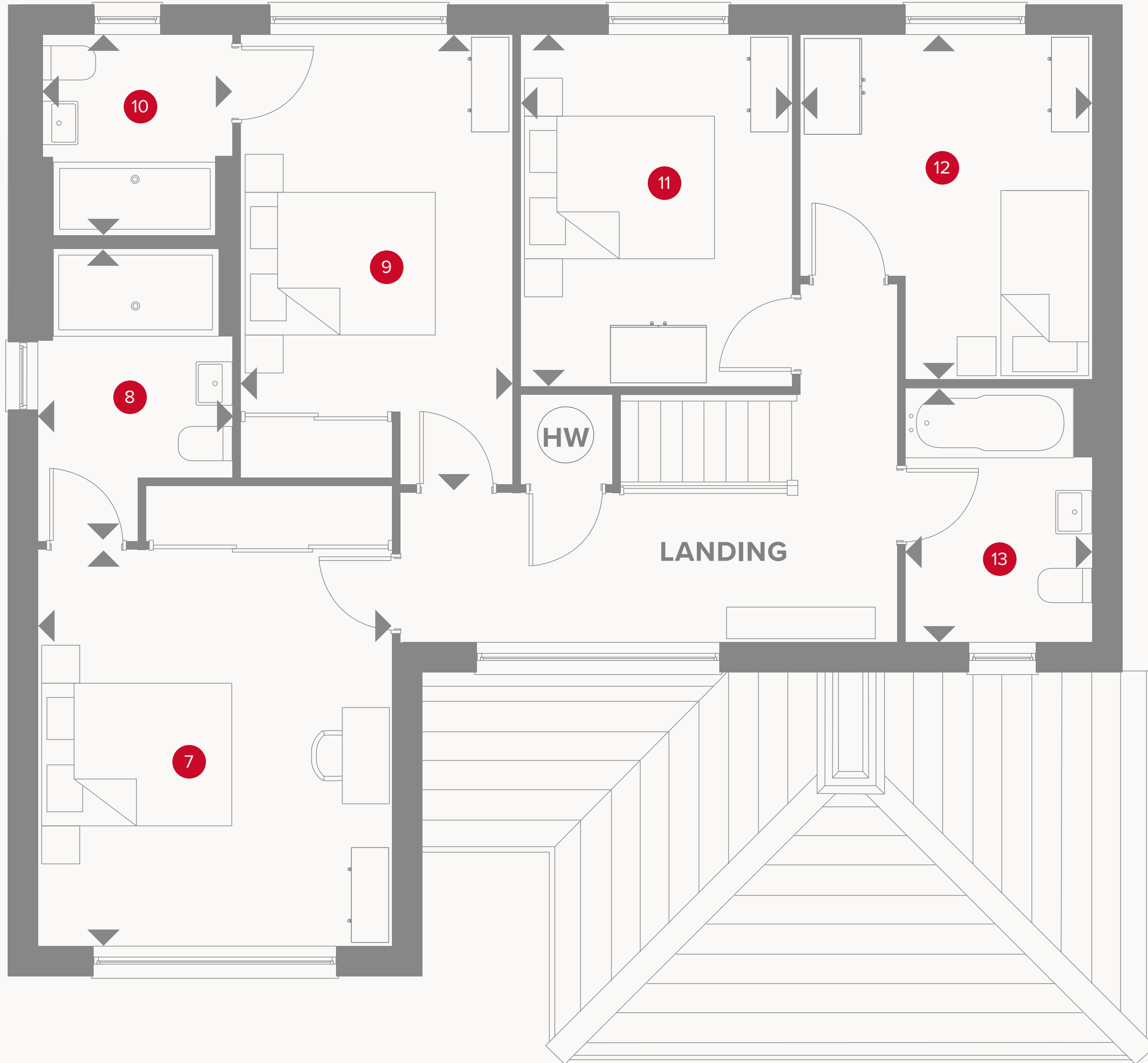

THE SUNNINGDALE FIRST FLOOR

7	Bedroom 1	15'8" x 12'0"	4.74 x 3.63m
8	En-suite 1	9'8" x 6'7"	2.91 x 1.98m
9	Bedroom 2	15'0" x 9'4"	4.54 x 2.82m
10	En-suite 2	7'2" x 6'2"	2.18 x 1.87m
11	Bedroom 3	11'11" x 9'1"	3.60 x 2.74m
12	Bedroom 4	11'8" x 9'11"	3.54 x 3.00m
13	Bathroom	8'7" x 6'4"	2.60 x 1.91m



**CONSUMER
CODE FOR
HOME BUILDERS**
www.consumercode.co.uk

Customers should note this illustration is an example of the Sunningdale house type. All dimensions indicated are approximate and the furniture layout is for illustrative purposes only. Homes may be "handed" (mirror image) versions of the illustrations, and may be detached, semi-detached or terraced. Materials used may differ from plot to plot including render and roof tile colours. Detailed plans and specifications are available for inspection for each plot at our Sales Centre during working hours and customers must check their individual specifications prior to making a reservation. Computer generated images are for indicative purposes only.

KEY

- ◀ Dimensions start
- HW** Hot water storage
- LH** Loft hatch