



WILMINGTON GRAND

FOUR BEDROOM HOME



 REDROW



WILMINGTON GRAND

FOUR BEDROOM HOME



 REDROW

WILMINGTON GRAND

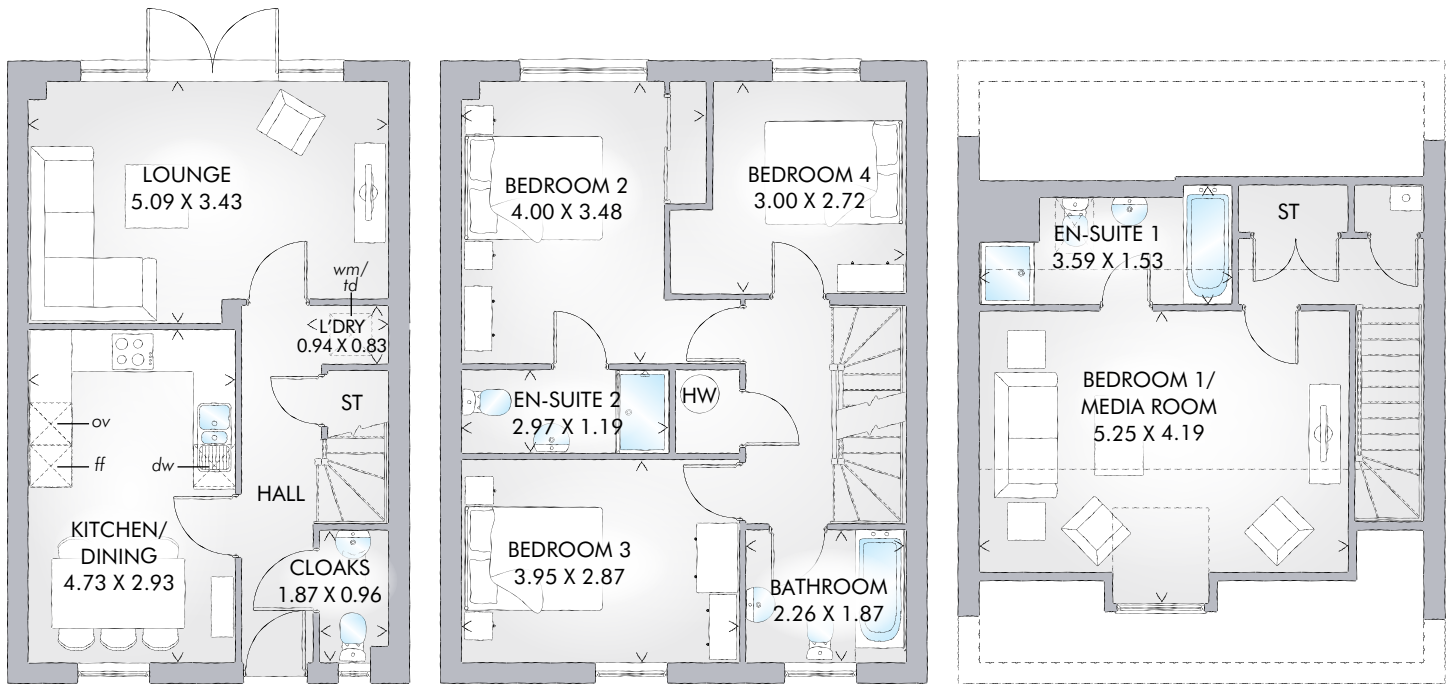

The Wilmington Grand combines the impressive architecture of the Regent Collection with the flexibility of three storey living. The accommodation is generously sized with a welcoming lounge, which is perfect for both entertaining friends and relaxing together as a family. Beautiful feature windows provide an abundance of natural light.

FOUR BEDROOM HOME

GROUND FLOOR

Lounge	16'8" x 11'3"	5.09 x 3.43 m
Kitchen/ Dining	15'6" x 9'7"	4.73 x 2.93 m
Cloaks	6'2" x 3'2"	1.87 x 0.96 m
Laundry	3'1" x 2'9"	0.94 x 0.83 m

FIRST FLOOR

Bedroom 2	13'2" x 11'5"	4.00 x 3.48 m
Bedroom 3	13'0" x 9'5"	3.95 x 2.87 m
Bedroom 4	9'10" x 8'11"	3.00 x 2.72 m
En-suite 2	9'9" x 3'11"	2.97 x 1.19 m
Bathroom	7'5" x 6'2"	2.26 x 1.87 m

SECOND FLOOR

Bedroom 1/ Media Room	17'2" x 13'9"	5.25 x 4.19 m
En-suite 1	11'9" x 5'1"	3.59 x 1.54 m

CONSUMER CODE FOR HOME BUILDERS

www.consumercode.co.uk

Customers should note this illustration is an example of the Wilmington^{Grand} house type. All dimensions indicated are approximate and furniture layout is for illustrative purposes only. Homes may be a 'handed' (mirror image) versions of the illustrations, and may be detached, semi-detached or terraced. Materials used may differ from plot to plot including render and roof tile colours. Detailed plans and specifications are available for inspection for each plot at our Sales Centre during working hours and customers must check their individual specifications prior to making reservation.

KEY Hob Oven Fridge/freezer Washing machine space Dishwasher space Tumble dryer space Hot water cylinder Cupboard

< Denotes where dimensions are taken from. All wardrobes are subject to site specification. Please see Sales Consultant for further details.

Traditional homes, built the way you remember

